

# Ownership Of Oregon Estuaries

N.E. 1/4 Section 3 T.25 S. R.13 W. W.M.  
1" = 200'

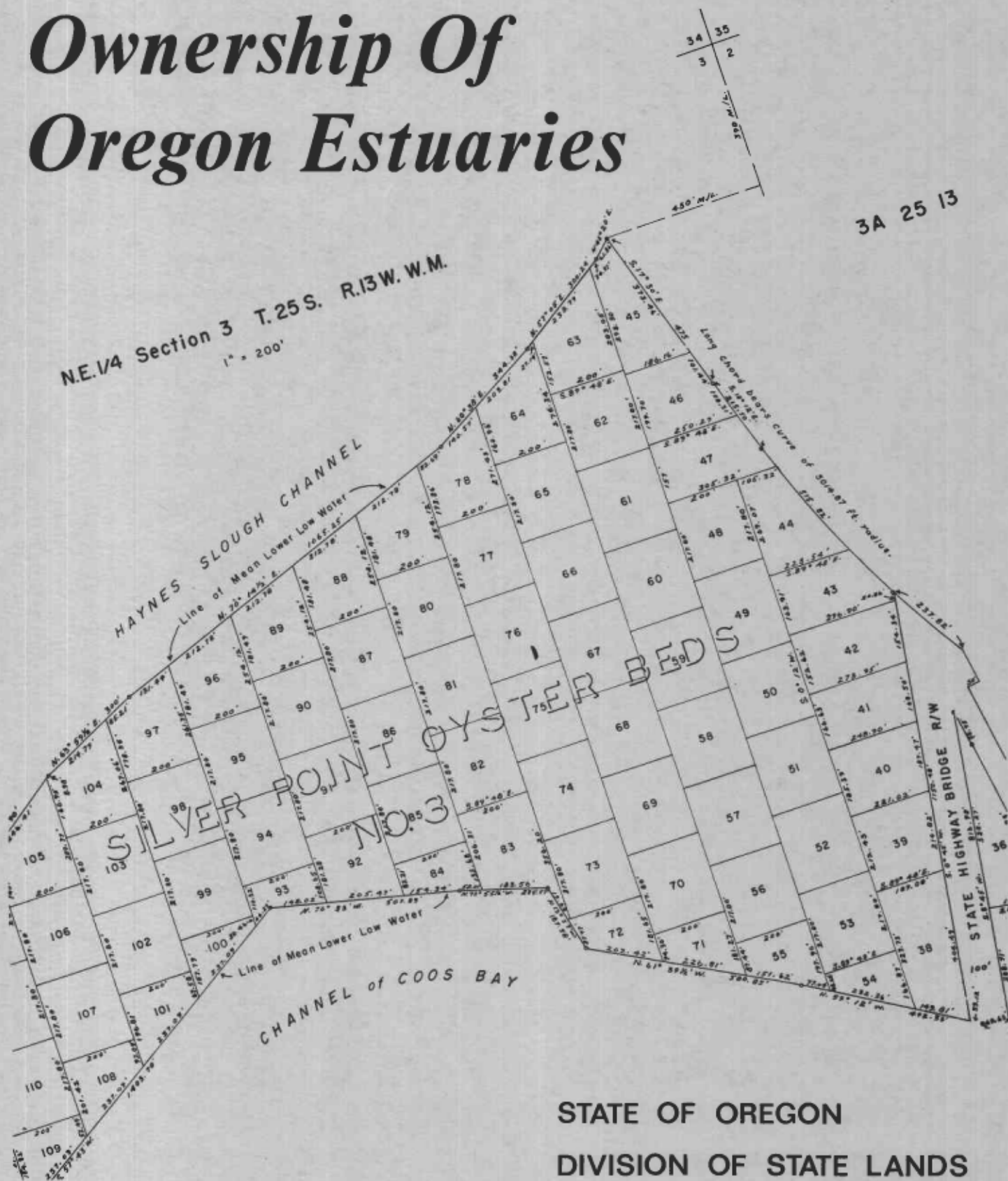

STATE OF OREGON  
DIVISION OF STATE LANDS

# OREGON ESTUARIES



DIVISION OF STATE LANDS

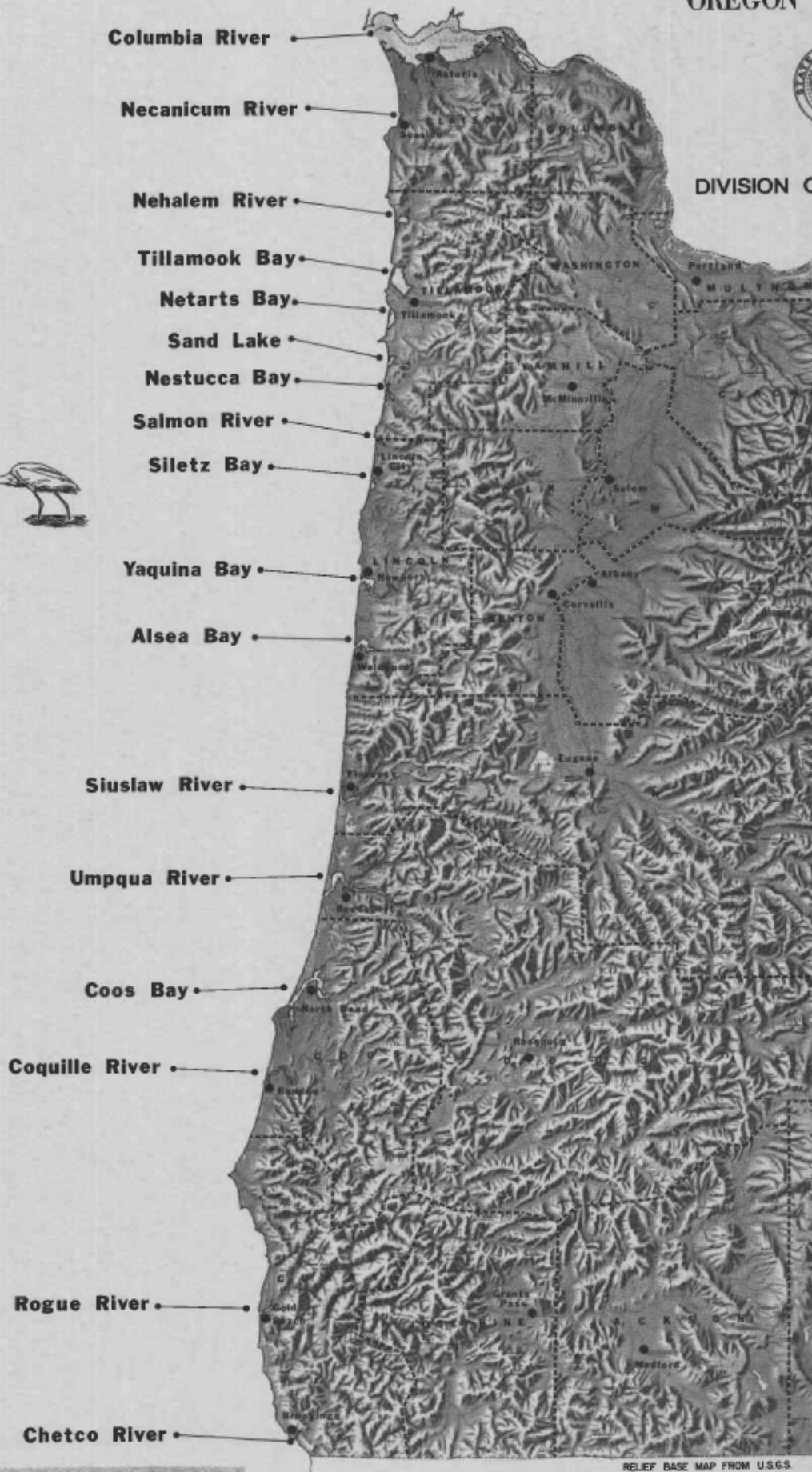



## DIVISION OF STATE LANDS

### OFFICE OF THE DIRECTOR

1445 STATE STREET • SALEM, OREGON • 97310 • Phone 378-3805

#### OREGON STATE LAND BOARD

TOM McCALL  
Governor

CLAY MYERS  
Secretary of State

JAMES A. REDDEN  
State Treasurer

WILLIAM S. COX  
Director

July 12, 1974

#### Ownership of Oregon Estuaries

Sometime ago, the Division of State Lands, working with funds provided by the United States Government, under the Emergency Employment Act of 1971, performed a study and analysis of the ownership of submersible lands (tidelands) in each of Oregon's major estuaries. The results of our study are contained in this booklet for your information.

As you will see when you examine these maps, the State of Oregon acting through the Division of State Lands, is a major landowner in almost every estuary. The Division exercises clear authority over all submerged land (lands lying below the Ordinary Low Water line) as none of these lands were ever sold to private individuals. The Division also exercises authority over the publicly owned tidelands or submersible lands, which have not been sold into private ownership. In addition, the Division also speaks to the public's interest in the rights of navigation and fishery over privately owned tidelands.

Our purpose in preparing these maps was to provide accurate up-to-date information on public and private ownership of estuarine lands for our land management purposes. We hope that this reduced size version will be useful to you.

Sincerely,

William S. Cox  
Director

PACIFIC OCEAN

GEARHART

9 STATE HIGHWAY DIVISION

CH-31  
CH-32

OSHD Zone Line

Geage Treatment Plant

CH-33  
CH-34

SEASIDE

21

28

15

22

27

Head of Tide

880,000

870,000

865,000

860,000

1,25,000

R 10 W WM



OREGON

46° 00' 00"

T 6 N

TYPE of OWNERSHIP



State of Oregon



Private



Port, County, Federal, or City

Head of Tide

MILL PONDS



Tideland Map compiled from May 1970 and Jan. 1971 aerial photography. Field photo identification Feb. 1973.

Control from Oregon State Dept. of Revenue Forest Cover Maps.

Oregon State Plane Coordinates North Zone.

Rectangular Grid.

TIDELAND OWNERSHIP MAP  
of  
NECANICUM RIVER  
STATE of OREGON  
DIVISION of STATE LANDS  
1973

PACIFIC OCEAN

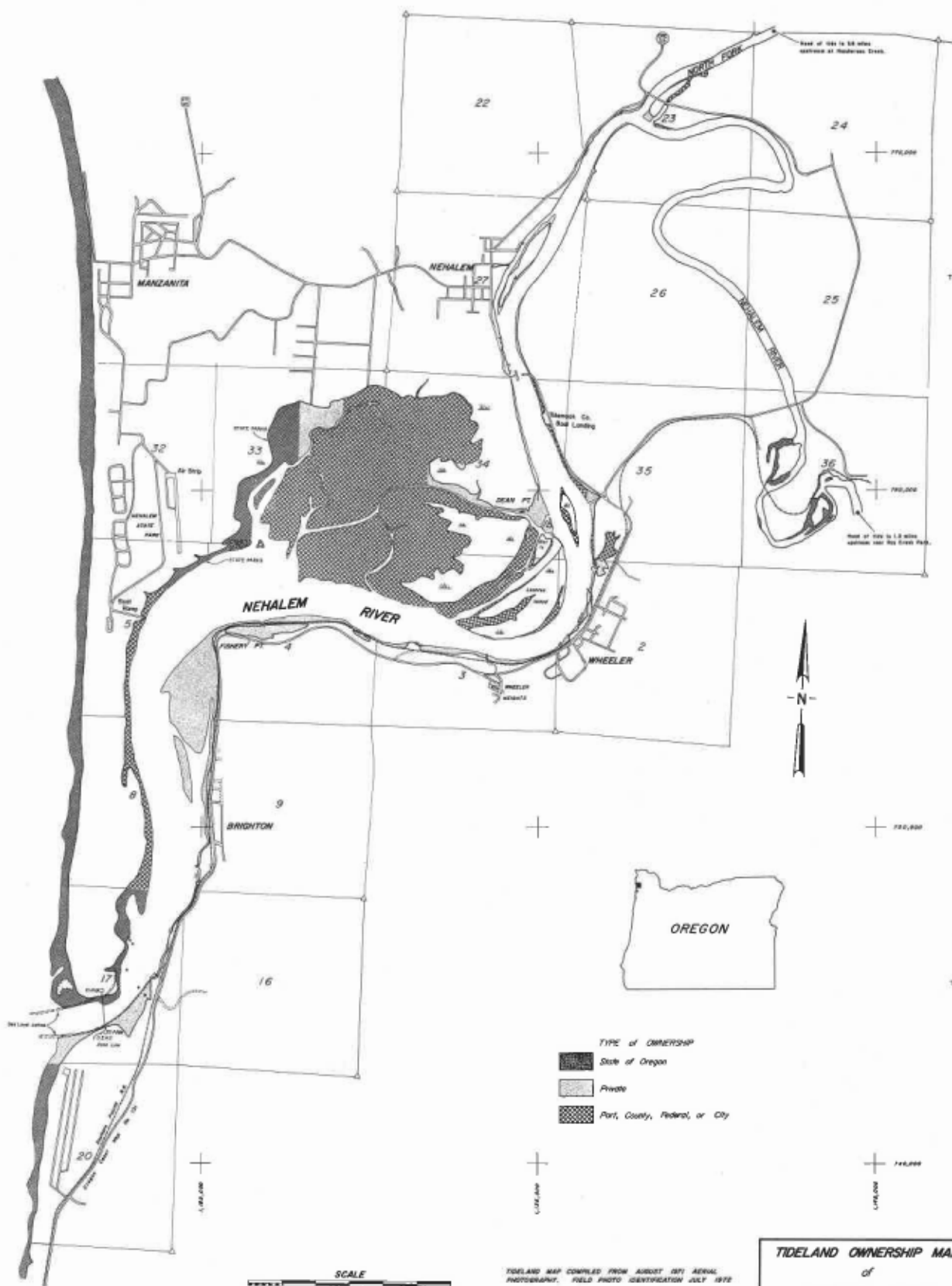

TYPE OF OWNERSHIP

- State of Oregon
- Private
- Port, County, Federal, or City

SCALE  
0 500 1000 1500 2000 2500 3000 3500 4000

TIDELAND MAP COMPILED FROM AUGUST 1971 AERIAL PHOTOGRAPHY. FIELD PHOTO IDENTIFICATION JULY 1972  
CONTROL FROM C.B.S. CHART NO. 4182  
OREGON STATE PLANE COORDINATES NORTH ZONE  
RECTANGULAR GRID

TIDELAND OWNERSHIP MAP  
of  
NEHALEM RIVER  
STATE OF OREGON  
DIVISION OF STATE LANDS  
AUGUST 1972

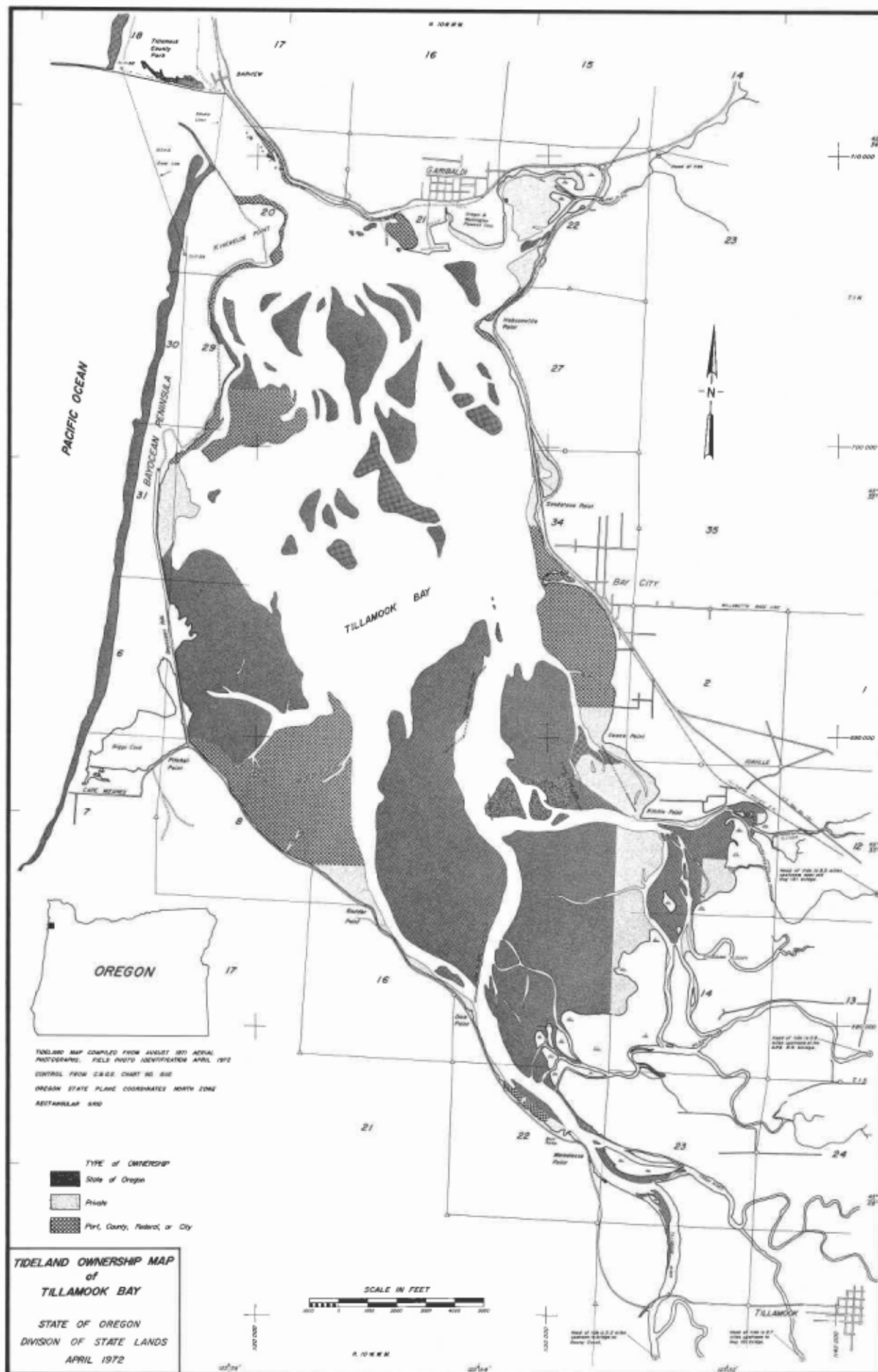

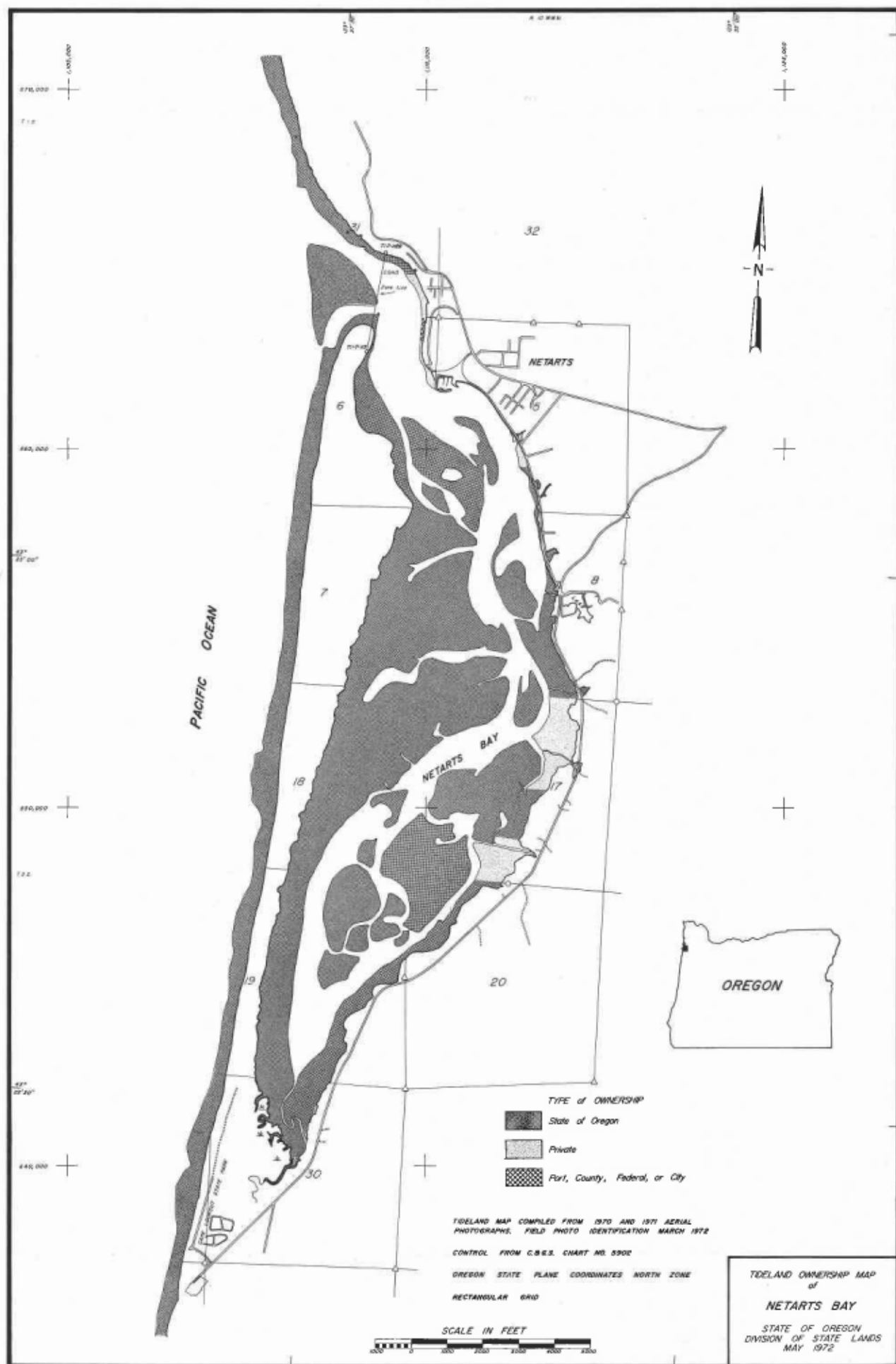

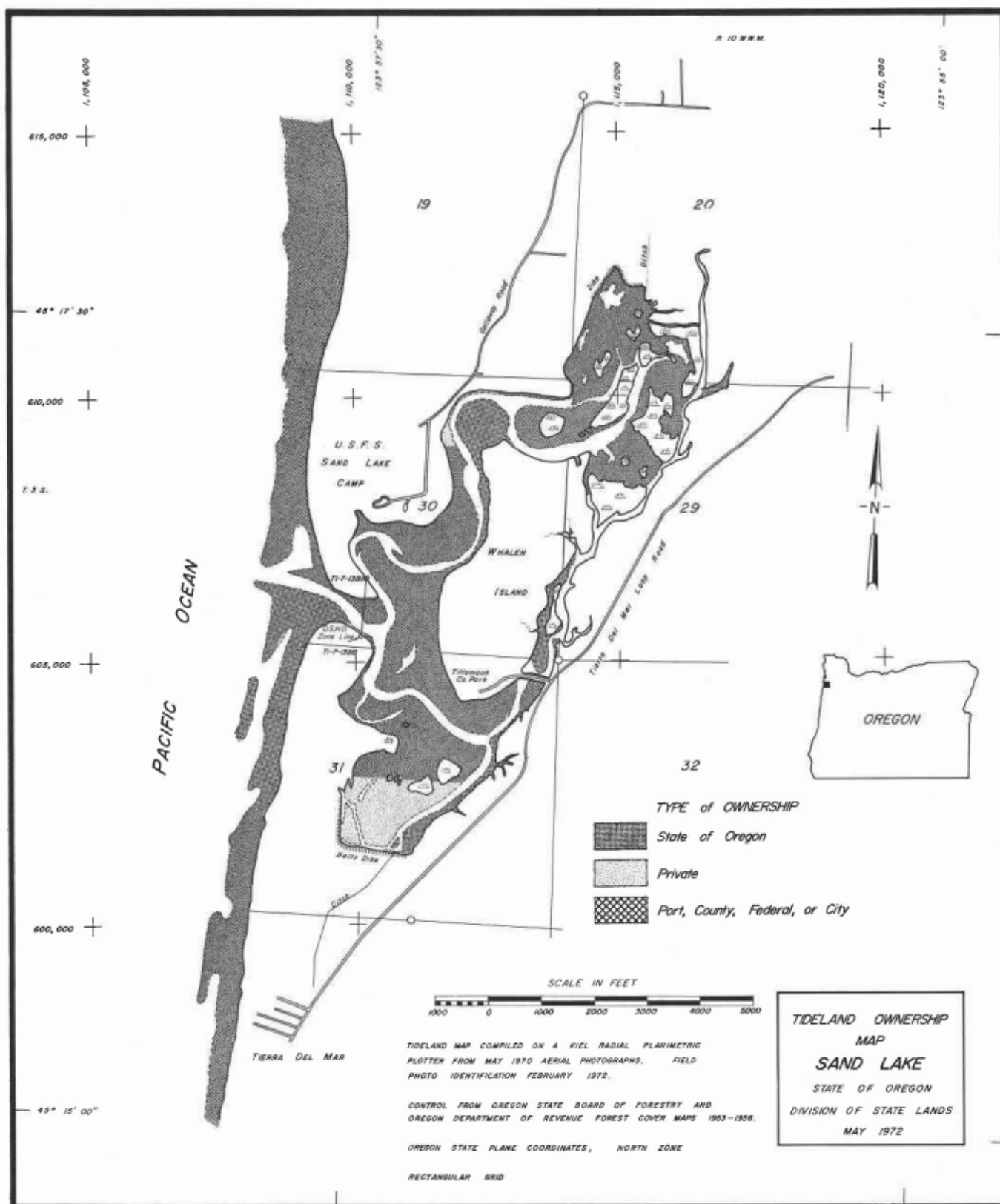

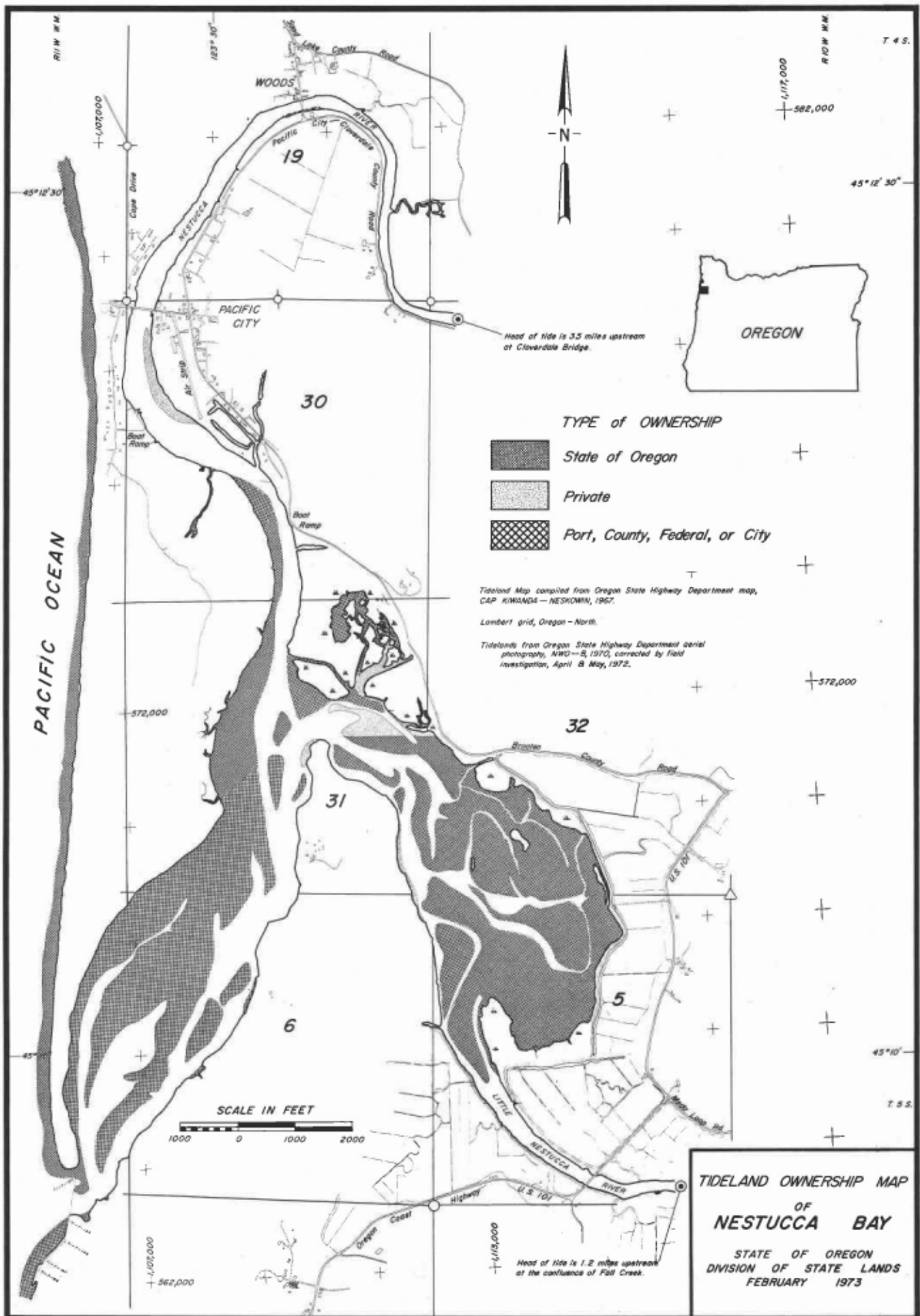

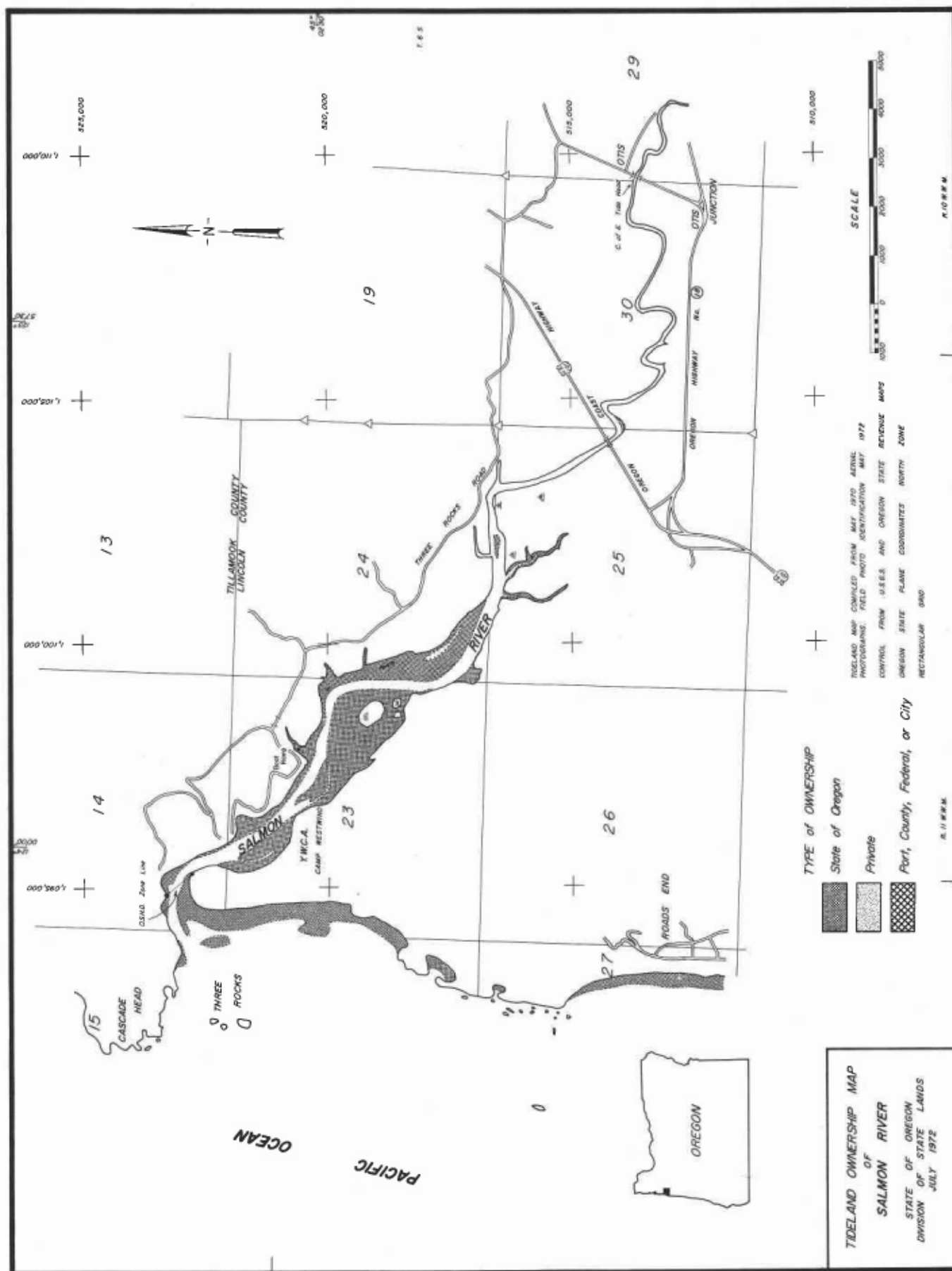

TIDELAND OWNERSHIP MAP  
 OF  
 SALMON RIVER  
 STATE OF OREGON  
 DIVISION OF STATE LANDS  
 JULY 1972

**TYPE OF OWNERSHIP**  
 State of Oregon  
 Private  
 Port, County, Federal, or City

TIDELAND MAP COMPILED FROM MAY 1970 AERIAL  
 PHOTOGRAPHS, FIELD PHOTO IDENTIFICATION MAP  
 CONTROL FROM U.S.G.S. AND OREGON STATE REVENUE MAPS  
 OREGON STATE PLANE COORDINATES NORTH ZONE  
 RECTANGULAR GRID

N. 10° 44' 30" W. 1:100,000

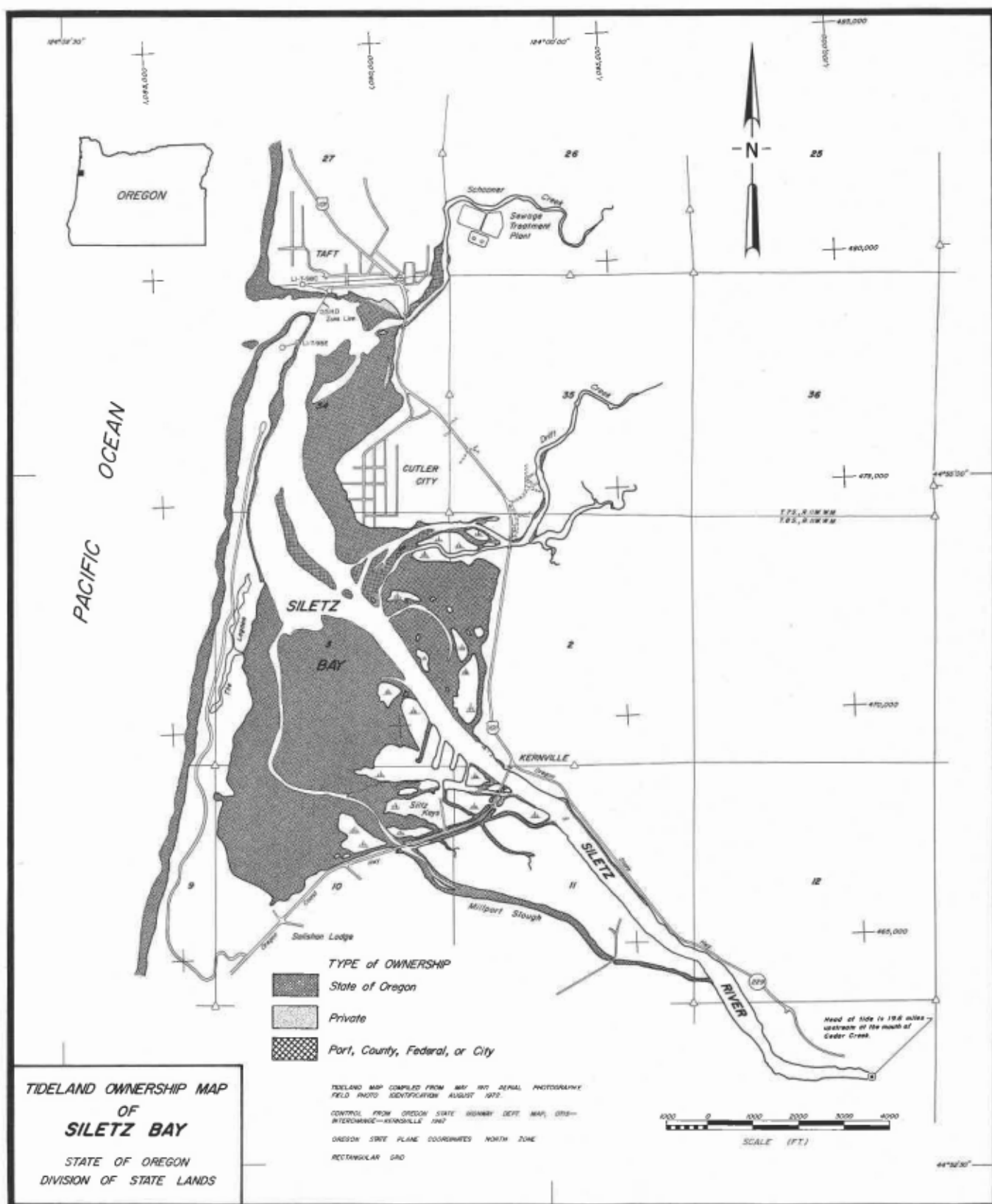

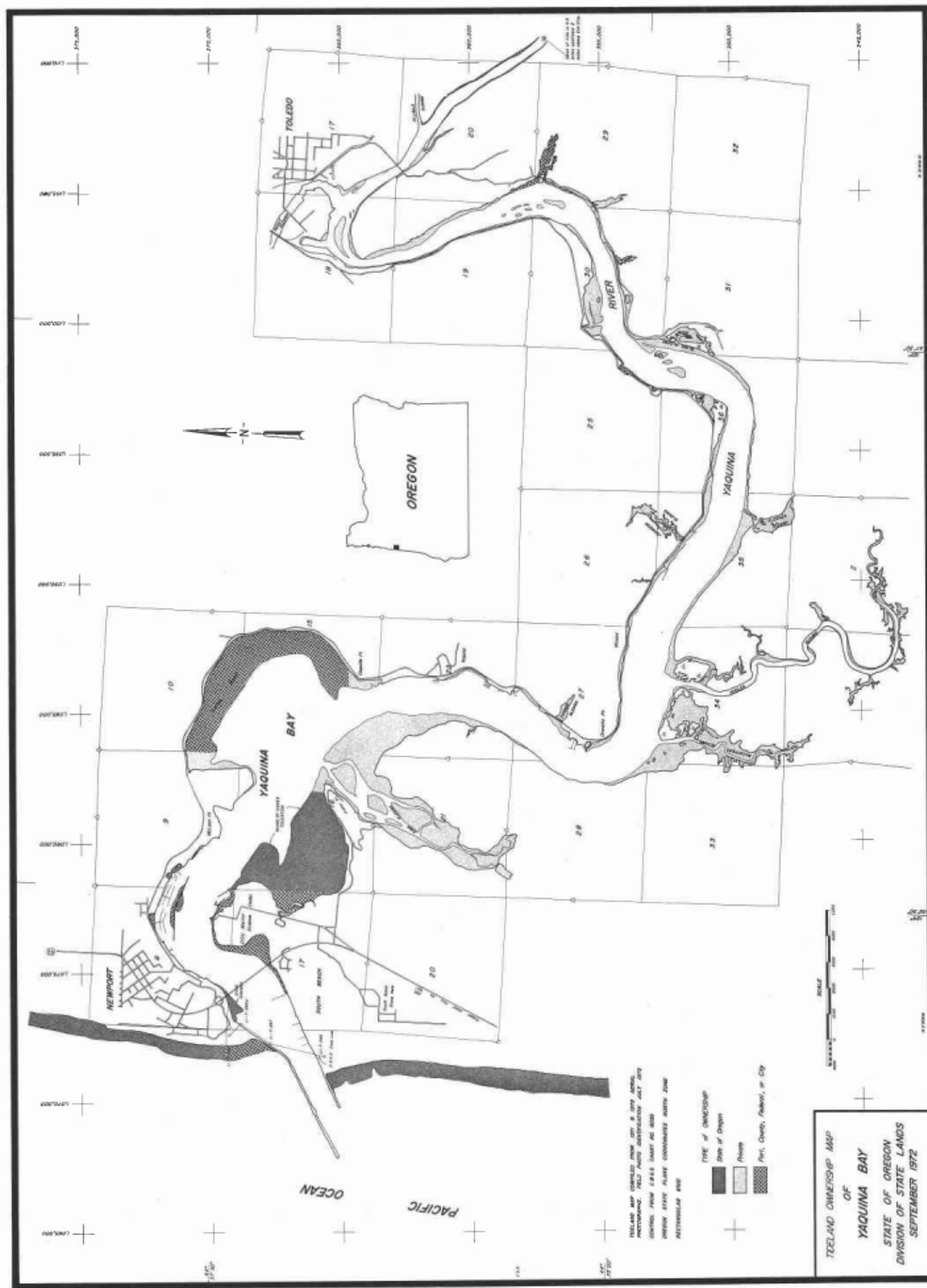



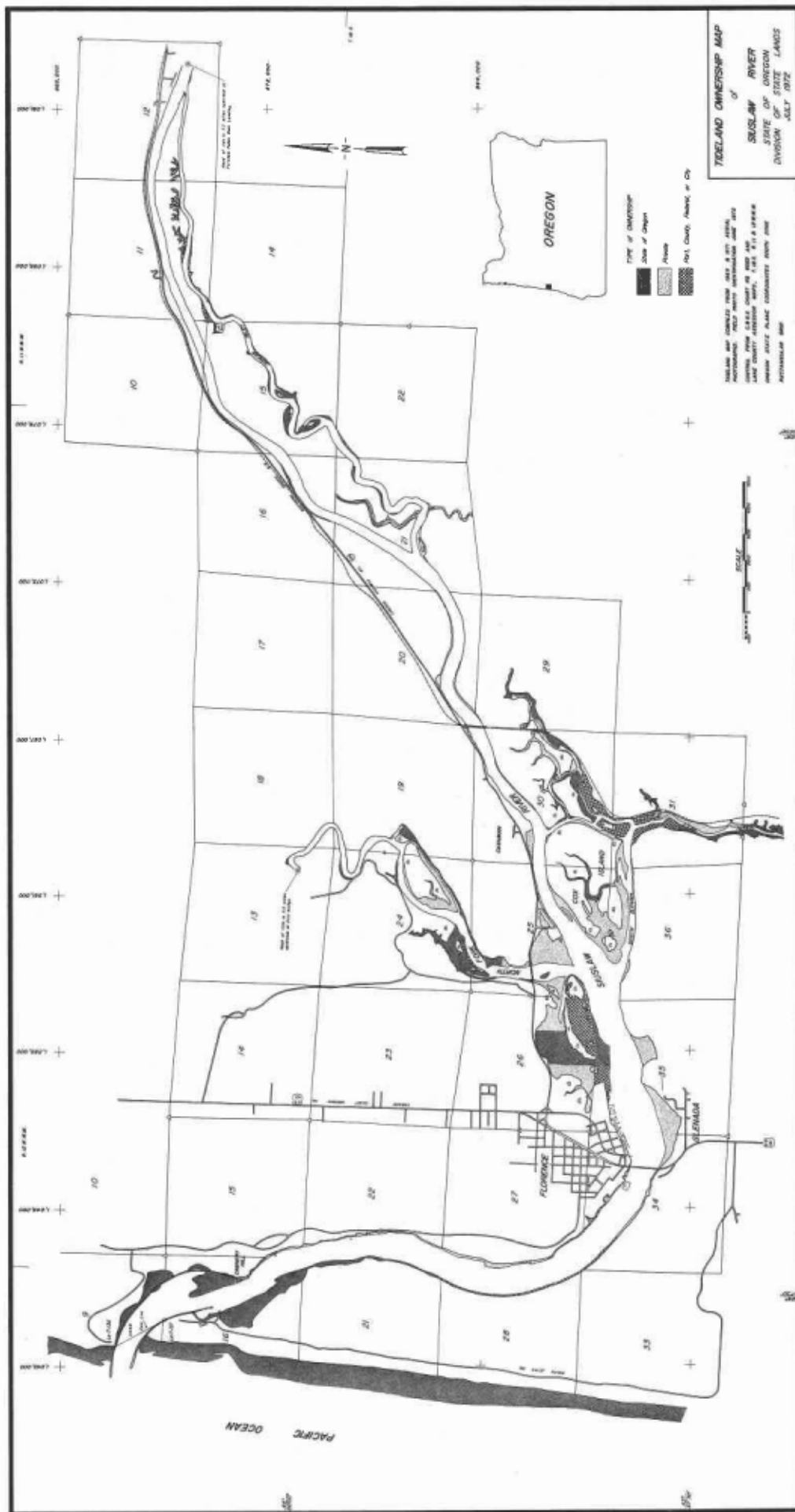



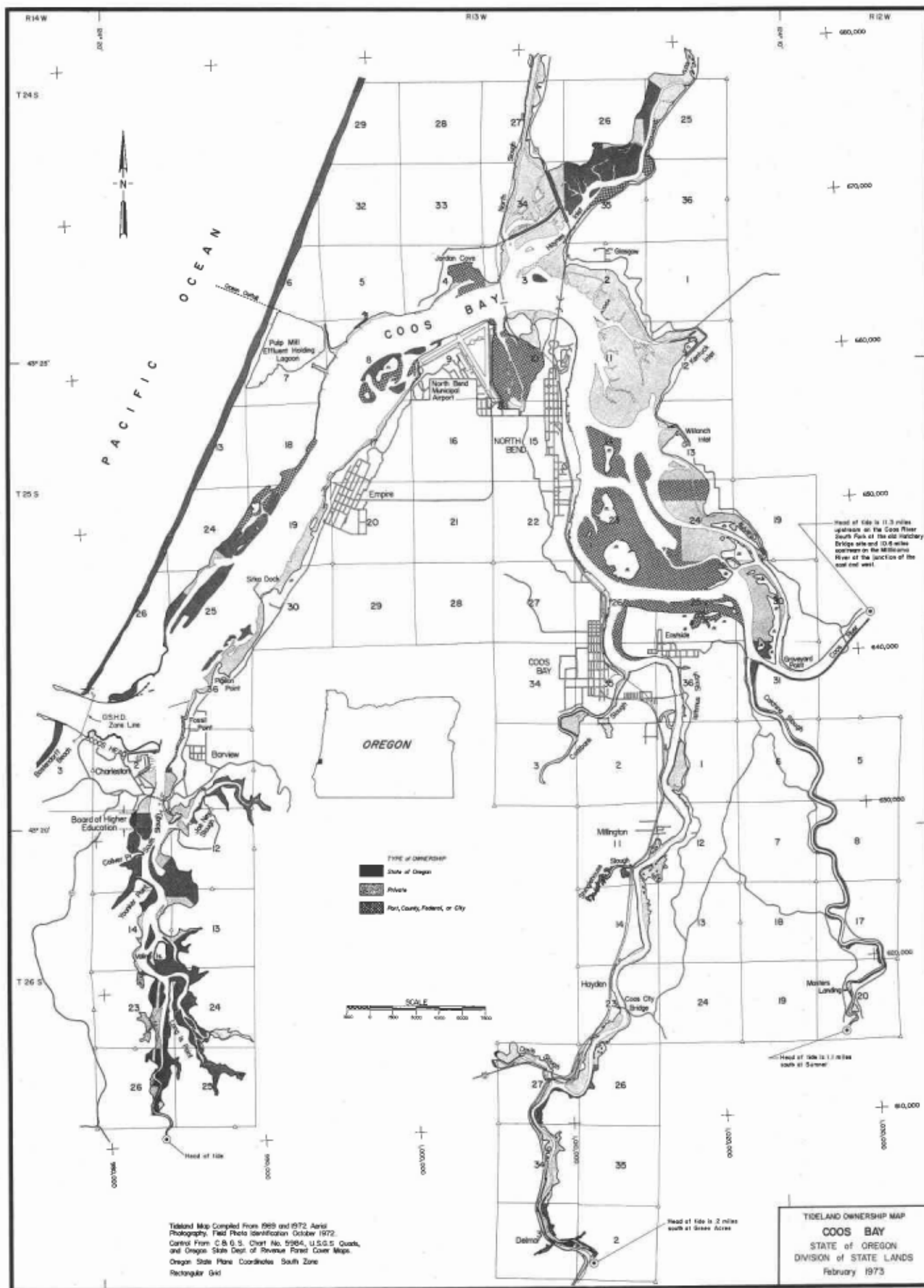

2

33

North

Ownership  
correction  
3/14/74

Jordan Cove

4

B A Y

C O O S

8

9

North Bend  
Municipal  
Airport

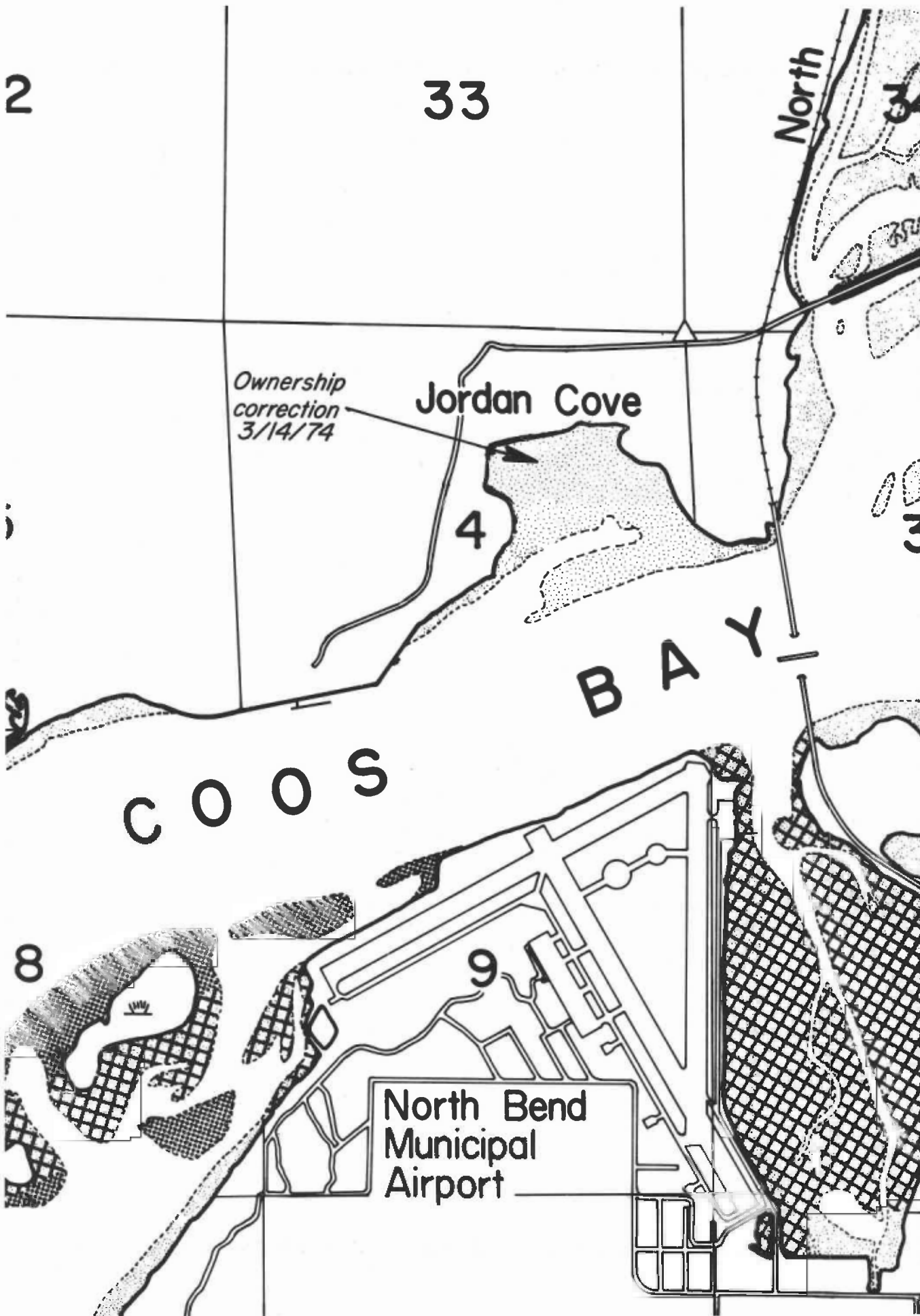

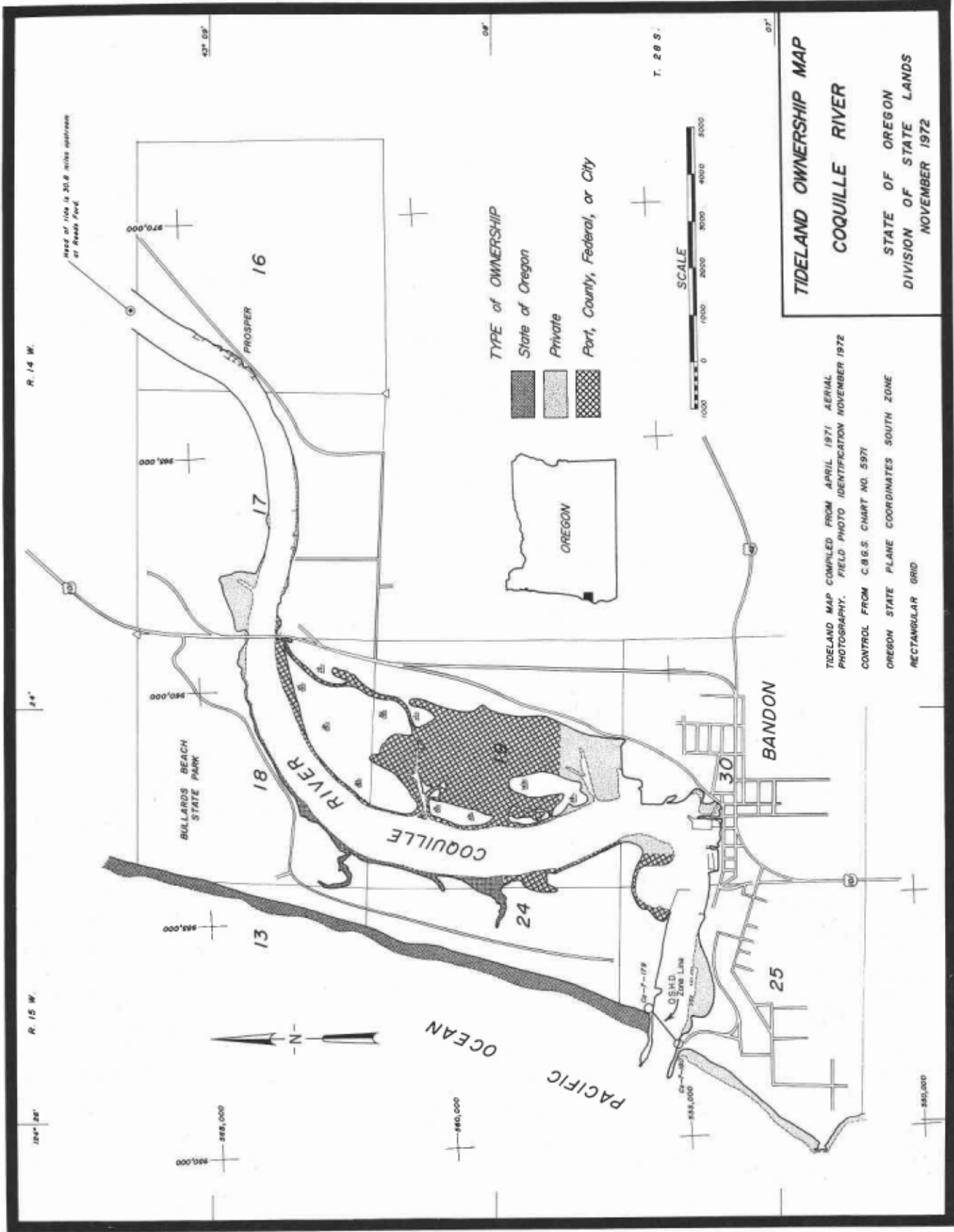

**TIDELAND OWNERSHIP MAP**  
**COQUILLE RIVER**  
STATE OF OREGON  
DIVISION OF STATE LANDS  
NOVEMBER 1972

TIDELAND MAP COMPILED FROM APRIL 1971 AERIAL  
PHOTOGRAPHY. FIELD PHOTO IDENTIFICATION NOVEMBER 1972  
CONTROL FROM C.B.G.S. CHART NO. 5971  
OREGON STATE PLANE COORDINATES SOUTH ZONE  
RECTANGULAR GRID

Tideflow Map compiled from June 1972 aerial  
 Photography. Field photo identification Feb. 1973.  
 Control from C.B.S. chart No. 5896 & Oregon State Dept.  
 of Revenue Forest Clear Maps.  
 Oregon State Plane Coordinates South Zone.  
 Rectangular Grid.

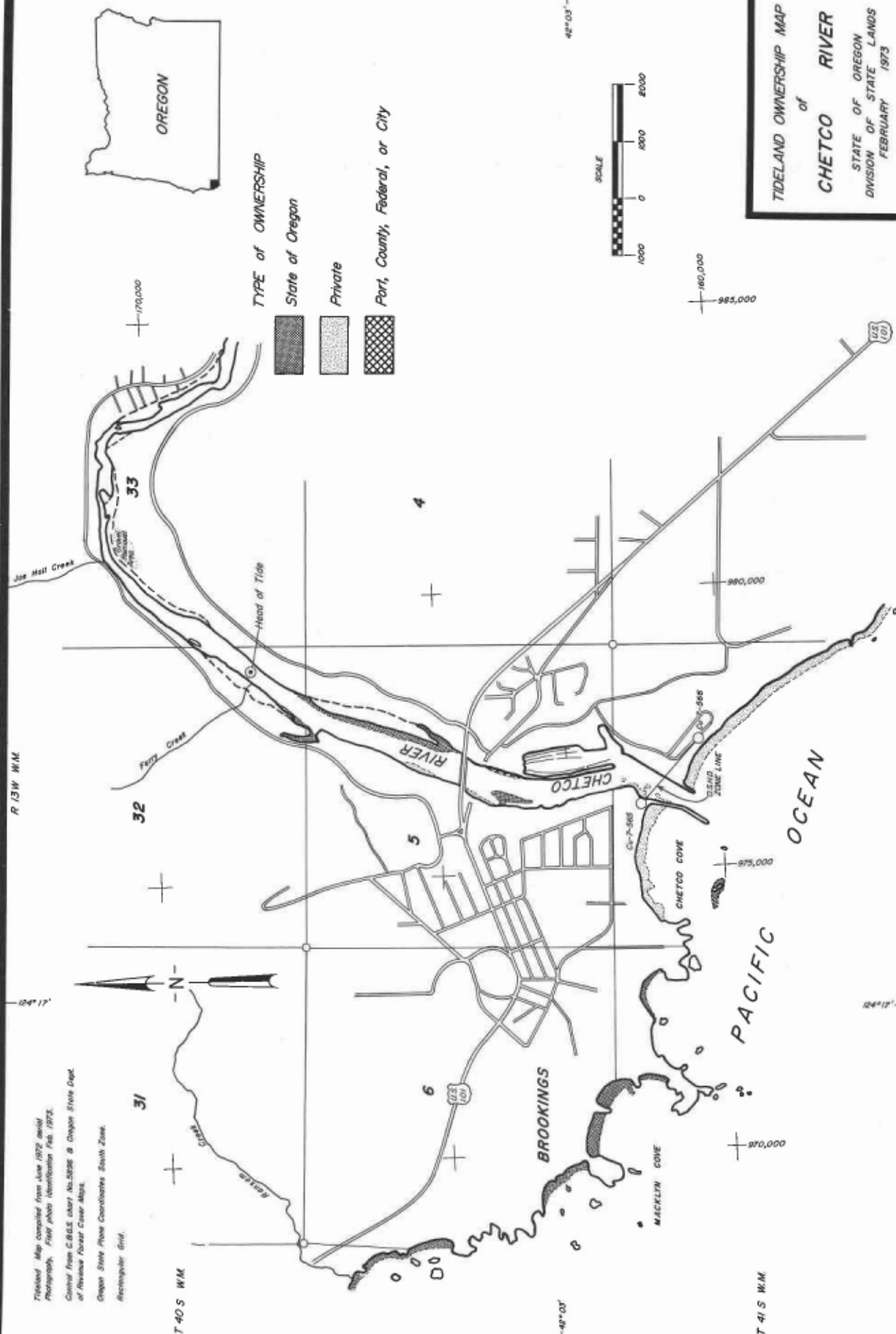

TIDEFLOW OWNERSHIP MAP  
 of  
**CHETCO RIVER**  
 STATE OF OREGON  
 DIVISION OF STATE LANDS  
 FEBRUARY 1973

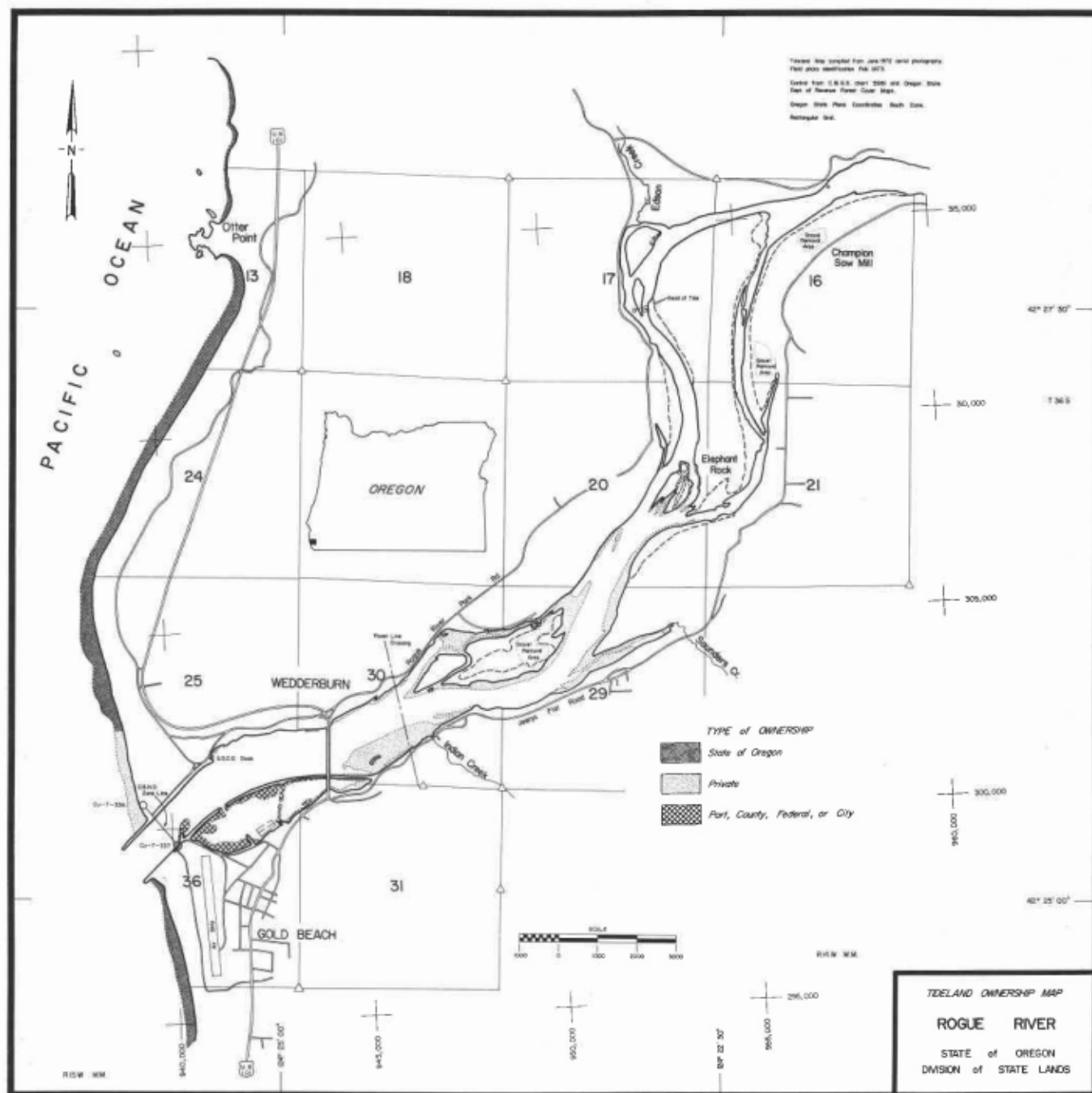

Nineteen and 40/100 Dollars  
Board of Commissioners for the sale of School, University

State of Oregon.  
in consideration of Eight and 65/100 Dollars,  
paid to the Board of Commissioners for the Sale of School, University  
and other State Lands, the State of Oregon does hereby grant, bargain,  
sell and convey unto his heirs and assigns, the following described  
situate in Good  
All the Tidy land from  
upon at Pine of School  
Township Twenty Six  
County Lane West of the  
ing to 200 Acres

South	
North	24% West
North	84% West
North	59% West
South	82% West
South	49% West
North	82% West
South	88% West
North	
North	64% West
South	17% East
North	56% East
South	20%
North	

Tide  
County, Oregon, is with  
and a little  
fourteen

TIDE  
DATE OF ORIGIN  
of the hand signed  
and written  
copy

Witness the Seal of the State, affixed  
 40<sup>th</sup> day of March 1888

12th day of March

Board of Land Commissioners,  
STATE OF OREGON.

*To Have and to Hold the said premises,*

OREGON. September 4, 1881  
Salem, W. not the State will want  
Wings the Post of  
1877. —

*N*, the said premises, with their appurtenances unto the  
and defend the same from all lawful claims whatsoever  
State, affixed this 26<sup>th</sup> day of January.

S 17°									est
N 19° 00'									26, Township
N 82° 30' E	198.0	"							hence
N 22° 30' E	567.6	"							nder Line
North	53.5	"							" "
		"							" "
		"							" "
East	528.0	"							ly sold to
		"							des
S 8° 00' W	1030.3	"							ander Line
S 18° 30' E	528.0	"							" "
S 39° 00' W	396.0	"							" "
S 11° 30' E	178.2	"							" "
S 32° 30' E	363.0	"							" "
S 19° 30' E	351.8	"							" "
West	773.0	"							to the line between
		"							Section 23 and Section 26
		"							along the section line to the place
		"							ing, containing 32.53 acres of tide land, fronting on
		"							Section 23, Township 26 South, Range 14 West of

# STATE OF OREGON

County, Oregon, to-wit:

Note in lower  
Beginning at the NW corner of Sec. 10, T. 2 S., R. 1 E.  
Sund claim N. 40° 45' W. 70 chains. S. 88° 45' 17' Chains.  
West chance S. 15° 45' W. 70 chains. S. 22° W. 42.25 chains to  
S. 20° W. 37 chains. S. 53° W. 14 chains. S. 22° W. 42.25 chains to low water, N. 33°  
NW corner N. 60° 30' W. 12.50 chains to place of beginning  
30' S. 78 chains. S. 66° 30' G. 12 chains to place of distinct  
beginning 97.50 acres of this land donated by  
T. J. Talley to Township

113  
to begin containing 29.83 acre wide  
at all points north of base.

Subject promises to this particular right of the purpose of the  
the channels, which is now located, moved and upon said lands or which  
may be dredged, dug, constructed or located thereon for the purpose  
of navigation, for harbor, boats, wharves, rapids, logs or other water  
craft, any or others, or for any purpose of navigation.  
right as herein expressly reserved for the State  
Subject promises to  
County, Oregon, to-wit:  
Boas, land, fronting on  
Riverside, City of Astoria

County, Oregon, to-wit:

STATE OF OREGON.

In Consideration of

*Hubert Pomeroy* Governor.  
*George M. Bixbee* Secretary.  
*John W. Webb* Treasurer.

OFFICE OF  
Board of Commissioners for School Lands  
AND COMMON SCHOOL FUND.

Salem, Oregon, Feb 9 1875-

Witness the seal of the State affixed this  
17<sup>th</sup> day of March 1886