

5A1

2-15-73

8

Storage

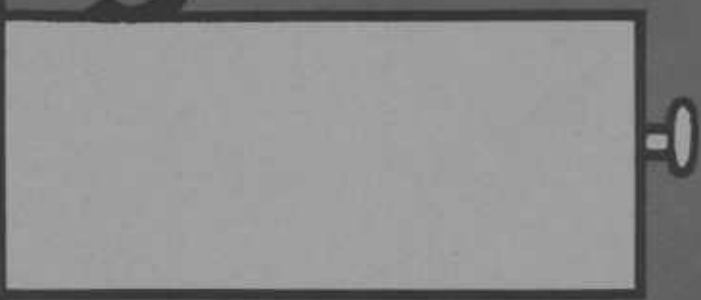

for new or remodeled homes

OREGON STATE UNIVERSITY EXTENSION SERVICE
FEBRUARY 1973 EXTENSION CIRCULAR 802

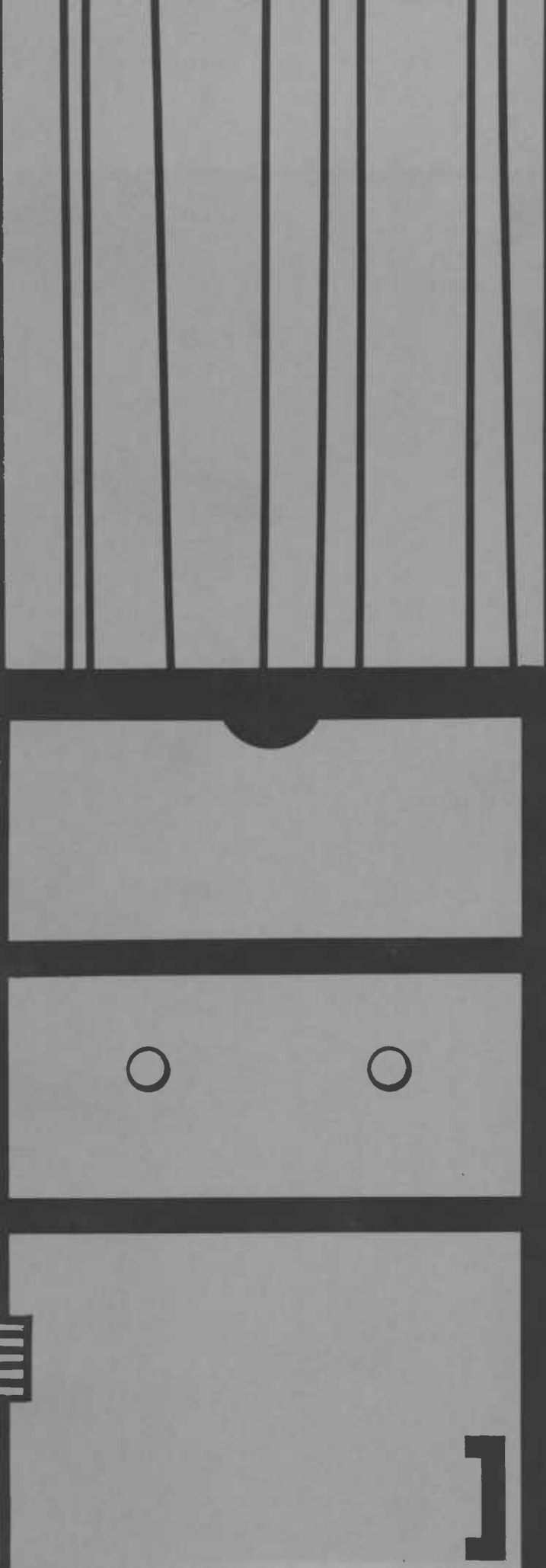

CONTENTS

Introduction	1
Guest Closet	2
Living Area Storage	2
Storage for Folding Tables and Chairs	3
Storage for Musical Instruments	3
Luggage	3
Laundry and Utility Room Storage	4
Clean Laundry Storage	5
Cleaning Equipment Storage	5
Storage for Learning, Study, or Home Business Centers	6
Sewing Storage	6
Dining Room Storage	8
Table Linens, Accessories	8
Bedroom Storage	9
Bedding Storage	10
Bathroom Storage	10
Recreation and Outdoor Sports Storage	11
Workshop	12
Garden Tool and Supply Storage	13

Acknowledgments

Editorial assistance was given by Dorothy Brown, Oregon State University Extension specialist. Illustrations used have been adapted from materials developed by the Illinois Small Homes Council, "Storage for Your House"; Washington State University Extension Bulletin No. 436.

STORAGE

for new or remodeled homes

Prepared by Judith Burrige

*Extension Home Economist
Oregon State University*

Adequate storage makes housekeeping easier. "A place for everything" encourages neatness and eliminates clutter.

Preliminary steps for planning for storage in a new home are to:

- Locate the rooms in the house plan.
- Determine the storage needed in each room according to activities that take place there.

In the case of remodeling, consider the room dimensions, then determine storage needs. Remember that added storage space reduces the square footage of the room.

Storage should be planned to fulfill the following needs:

- Provide family members easy access to items stored.
- Be convenient for family members to use.
- Provide protection to the items stored.
- Provide maximum utilization of space.
- Provide for flexibility of use.
- Enhance the total appearance of the room.
- Be easy to maintain.
- Be economical.

This bulletin is planned to give you background information about storage space. Subjects discussed are items that have to be stored, minimum-optimum storage needs, and suggested dimensions of storage space. An architect, designer, or builder

should be consulted when building or remodeling to develop plans for storage space.

When planning storage, consider the type of door to be used for cabinets and closets. Hinged doors that open out into the room require space to swing which may block traffic lanes. Bi-fold doors take little room when opened and give complete access to the contents of the closet. Sliding doors take no room when open, but block half of the contents of the closet.

Also consider the alternative of fixed shelving versus pullout shelves or trays in cabinets. Pullout shelves utilize space better than fixed shelves because no head room is required for reaching into the cabinet for grasping items. Visualize how the storage unit will look when finished. The unit should be attractive as well as functional and be in keeping with the style of the room.

Some storage units are multi-purpose and therefore can be used in many rooms. Location of specific types of storage units depends on the basic houseplan and the activities of the family who occupy the finished house.

The type of storage you plan for your home is determined by—

- items you have to store
- money available to provide for storage
- space available to build storage
- your personal preference
- activities of family

Guest Closet

A guest or entrance closet says welcome to the guest. It provides them with a place for their wraps. A grooming area may be included for convenience of company. Family members may also want to leave outer wraps in the entrance closet.

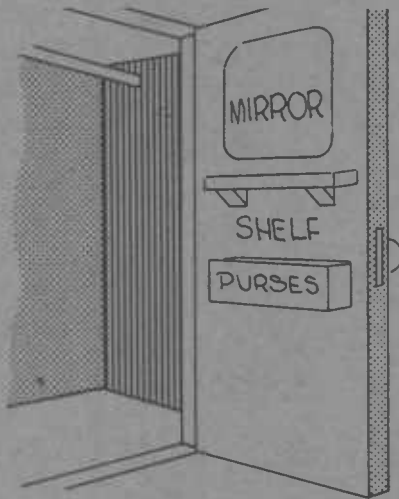

GUEST CLOSET

Needs inside of guest closet.

Height: full
 Depth: 24" minimum
 26" more desirable
 30" most desirable for bulky coats
 Width: 36"

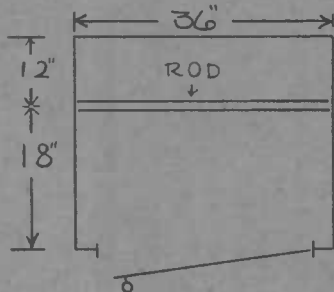

FLOOR DIMENSIONS

Items to be Stored

- Coats
- Hats
- Boots
- Umbrellas
- Purses

Minimum Storage

- Clothes rod
- Shelf for hats and purses

Optimum Storage

- Clothes rod
- Shelf above rod
- Ventilated rack for boots
- Mirror and shelf to hold grooming aids
- Umbrella rack or stand
- Shelf for purse storage

Living Area Storage

The concept of living area storage can be applied to any room in which the family members engage in recreational activities, either individually or as a group. The room could be a family room, a recreation room, or a living room depending on the house plan. The recreational activities of the family determine the type of storage needed.

Items to be Stored

- Games and recreation supplies
- Magazines
- Books
- Wood (for fireplace)
- Folding tables and chairs
- Musical instruments and equipment
- Hobby supplies
- Paperback books

Minimum Storage

- Cabinet
- Closet

Optimum Storage

- Cabinet for games
- Cabinet, shelf for magazines
- Cabinet for firewood
- Closet or cabinet to store folding tables and chairs
- Cabinet to store musical instruments or supplies
- Cabinet to hold hobby materials
- Bookcase 12" deep for books
- Bookcase 6" deep for paperbacks

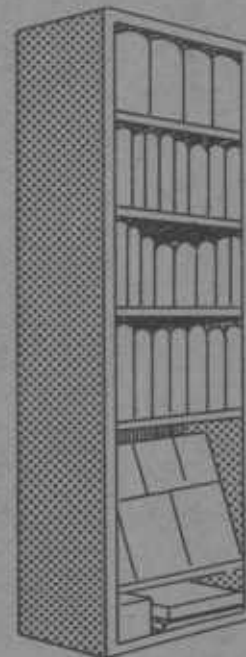

BOOKCASE

Storage for Musical Instruments

Width: as needed (1-1½" per book)
 Height: as needed; adjustable shelving

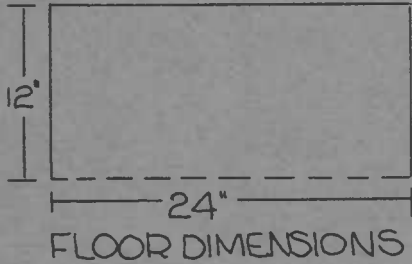

Storage for Folding Table and Chairs

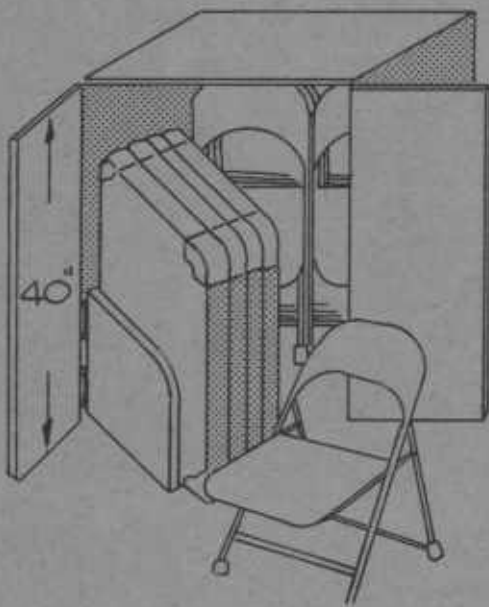

Width: minimum 36" depends on width of tables and chairs to be stored.
 Height: 40" or height of tables and chairs, plus 6"

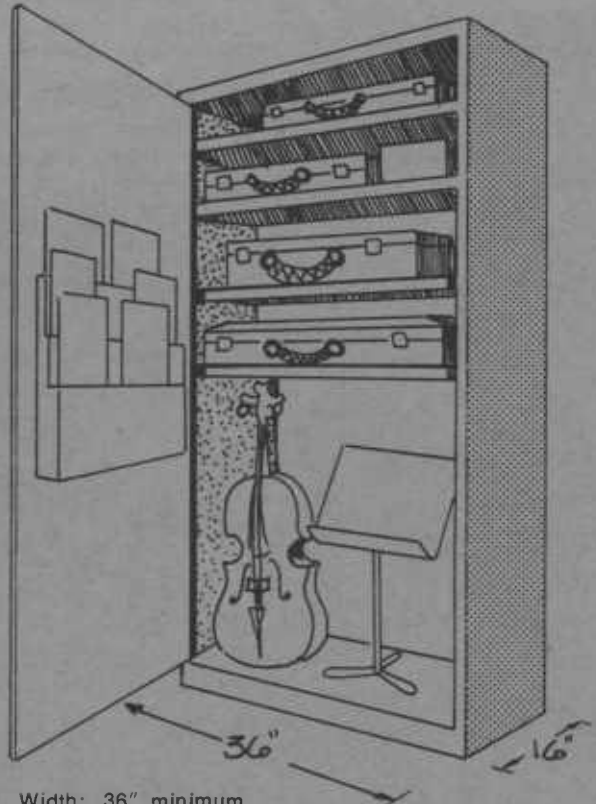
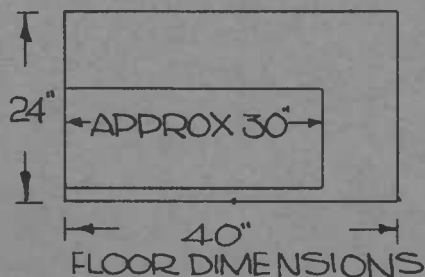

Width: 36" minimum
 Height: variable
 Shelf height should be adjustable.

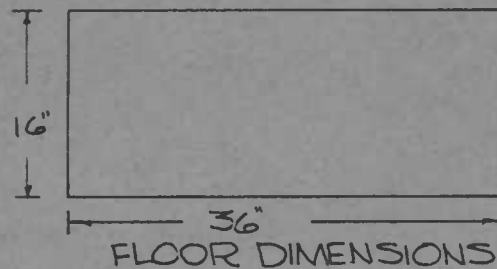

Luggage

Luggage is often stored in dead storage areas or on high shelves of closets used for other purposes. A cabinet designated for luggage storage will utilize space more efficiently. Plan storage of luggage to be away from the main traffic areas of the house; provide for easy access to the cabinet.

Items to be Stored

- Large suitcases
- Small suitcases
- Soft, fold-over bags
- Trunks

Minimum Storage

- Space in dead storage area

Optimum Storage

- Large cabinet with adjustable shelving

	Depth	Width	Height
Dress trunk	20"	36"	24"
Metal locker	15"	27"	9"
Man's			
3-suiter	18"	24"	8"
2-suiter	17"	22"	7"
Woman's			
Pullman case	13"	21"	7"
Weekend case (two stored)	12"	21"	7"
Train case	9"	12"	5"

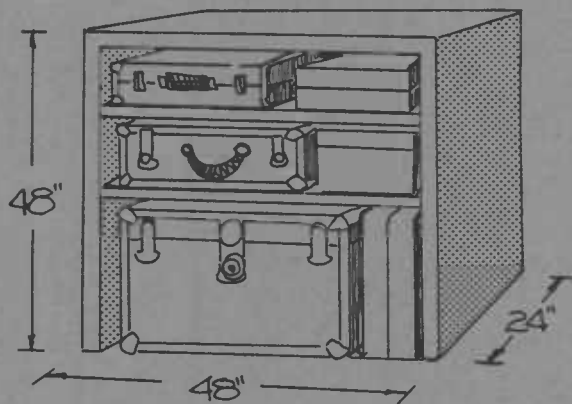

LUGGAGE CABINET

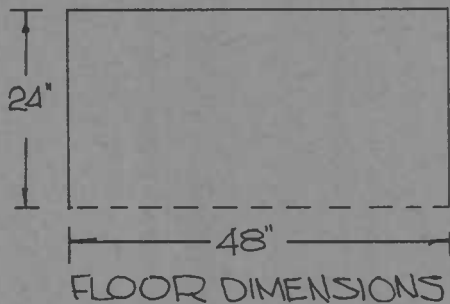

FLOOR DIMENSIONS

A drip-dry closet with a heat lamp and a floor drain eliminates the need for hanging handwashed items in the bathroom. Often a fiber glass basin with drain is set into the floor to catch drips.

Ironing and mending equipment are used more efficiently when incorporated as a part of the laundry room.

Items to be Stored

- Soiled laundry
- Clean laundry
- Stain removal supplies
- Detergent, laundry supplies
- Mending supplies
- Ironing equipment and supplies
- Utility-outdoor clothes

Minimum Storage

- Shelf for laundry supplies
- Hamper for soiled laundry
- Bins or cabinets for clean laundry

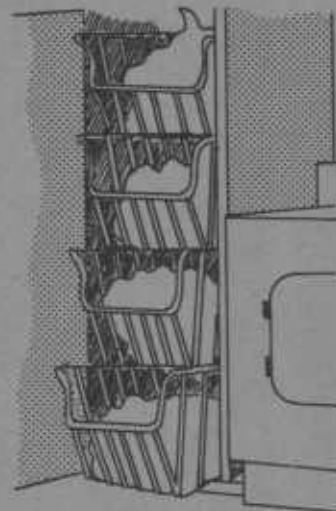

Soiled Laundry Storage

Laundry and Utility Room Storage

The laundry and utility room may be an area separate from the rest of the house or an area located in the kitchen, family room, or hallway.

Provide for storage and sorting of soiled clothing. Separation of soiled and clean laundry is important for sanitation and is a necessity for laundry areas. Ideally several bins which enable storing of soiled clothes according to fabric and color makes sorting clothes easier when laundering. After the laundry is dried it can be folded and put into clean laundry bins for family members to pick up and put away.

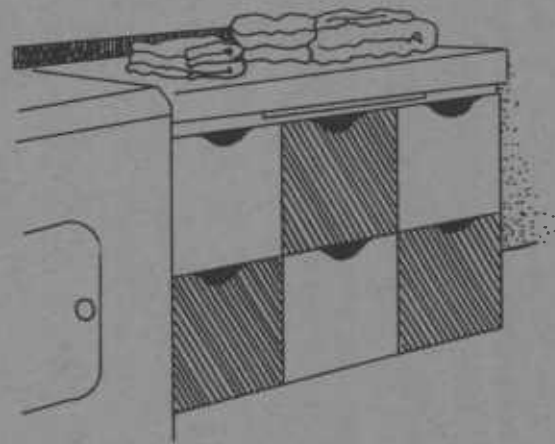

Clean Laundry Storage

Optimum Storage

- Cabinet for detergents and laundry supplies
- Hamper for soiled laundry
- Bins or cupboard for clean laundry
- Drip-dry closet
- Cabinets for mending equipment
- Cabinets for ironing equipment
- Closet for work, outdoor clothes

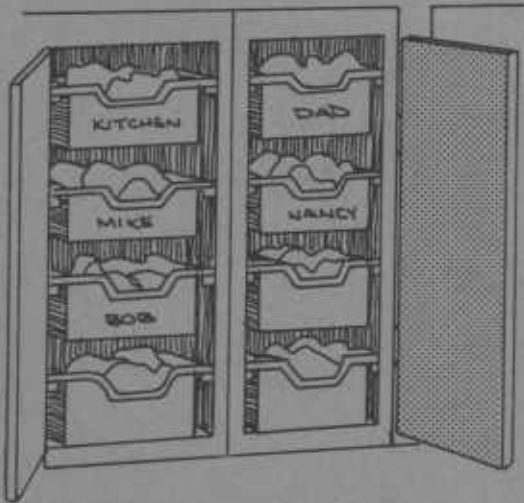

CLEAN LAUNDRY STORAGE

Cleaning Equipment Storage

Cleaning closets should be located on each floor of the dwelling. Easy access to equipment stored in them is a requirement. You may want to provide storage space for dining room table leaves and the ironing board in the cleaning closet. Include two shelves in the closet to hold cleaning supplies.

Cleaning supplies that are used exclusively in the bathroom or the kitchen should be stored in a cupboard in the respective rooms.

Items to be Stored

- Vacuum cleaner attachments
- Electric broom
- Rug cleaner
- Floor polisher
- Hand broom
- Dust mop
- Dust pan
- Dusting cloths
- Cleaners, waxes, and polishes

Minimum Storage

- Centrally located closet for all supplies

Optimum Storage

- Centrally located closet on each floor of the house

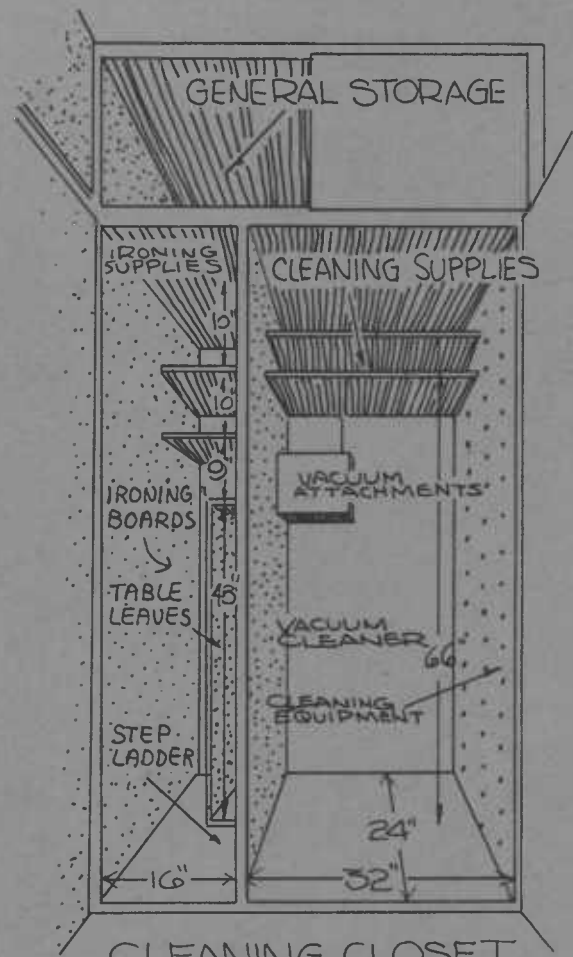

CLEANING CLOSET

Width: 24", 36" and 48"
Height: full

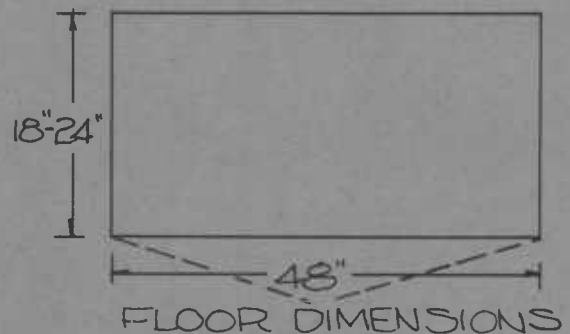

Cleaning Closet

Storage for Learning, Study, or Home Business Centers

Centers for study, learning, and conducting home business may be located in one multi-purpose area or be a part of another room such as the family room, kitchen, or living room. Location should be determined by the room available and convenience to family members using the centers.

If recording and projection equipment are to be used for both learning and hobby purposes, plan for additional storage for tapes and films. Plan to provide for adequate lighting.

Items to be Stored

Family Business Center

- Mail
- Bills
- Important papers
- Desk supplies
- Stationery

Study and/or Learning Center

- Books
- Reference materials
- Projection and recording equipment
- Films, tapes, records
- Photographic supplies, equipment

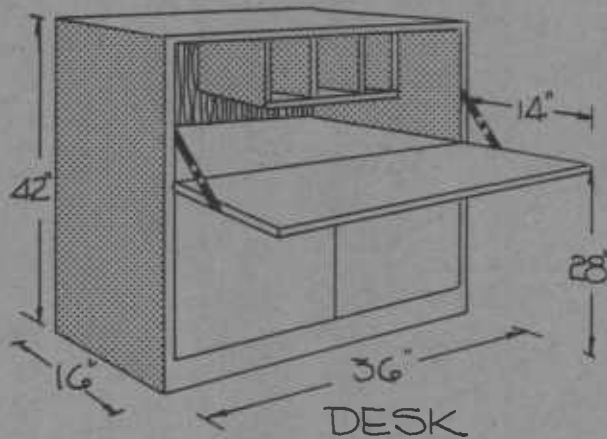

Writing surface should be 28" above the floor.

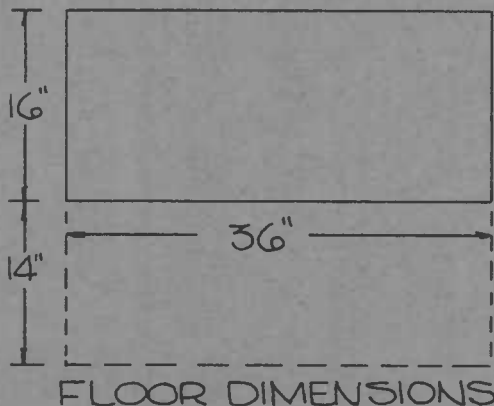

Provide for 14" deep writing space.

Minimum Storage

- Area to put desk
- Area to put file
- Portable shelving

Optimum Storage

- Built-in desk in study or kitchen
- Storage for bills, desk supplies, stationery
- Built-in book shelves with adjustable shelving
- Cabinets for storing camera, projection equipment, films, slides
- Storage for record player or recorder
- Storage for records, tapes
- Storage for electrical cords, etc.

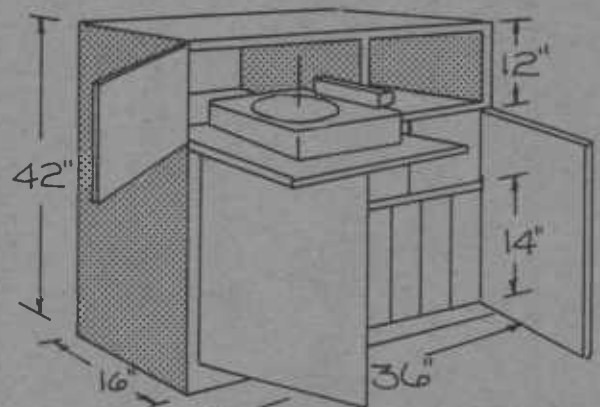

RADIO PHONOGRAPH

Sewing Storage

The location of sewing storage depends on the wishes and needs of the homemaker. It could be a part of the laundry room, family room, or a guest bedroom. The sewing area needs to provide a cutting, stitching, and pressing center. Storage needs to be provided for equipment used in each center. Often a cutting table is built into the sewing storage cabinet.

Items to be Stored

- Fabric, trims
- Patterns
- Thread and notions
- Cutting equipment
- Dress form
- Pressing equipment and supplies
- Sewing machine

Minimum Storage

- Drawer space for fabric and equipment
- Area in closet to store machine, pressing equipment

Optimum Storage

- Built-in cabinet
- Drawers or trays for fabric
- Drawers for notions, trims, thread
- Drawer for cutting equipment
- Closet space for dress form
- Drawers and shelving for pressing supplies
- Space for sewing machine
- Space for pressing boards (skirt boards, sleeve boards)
- File for patterns
- Space for measuring equipment

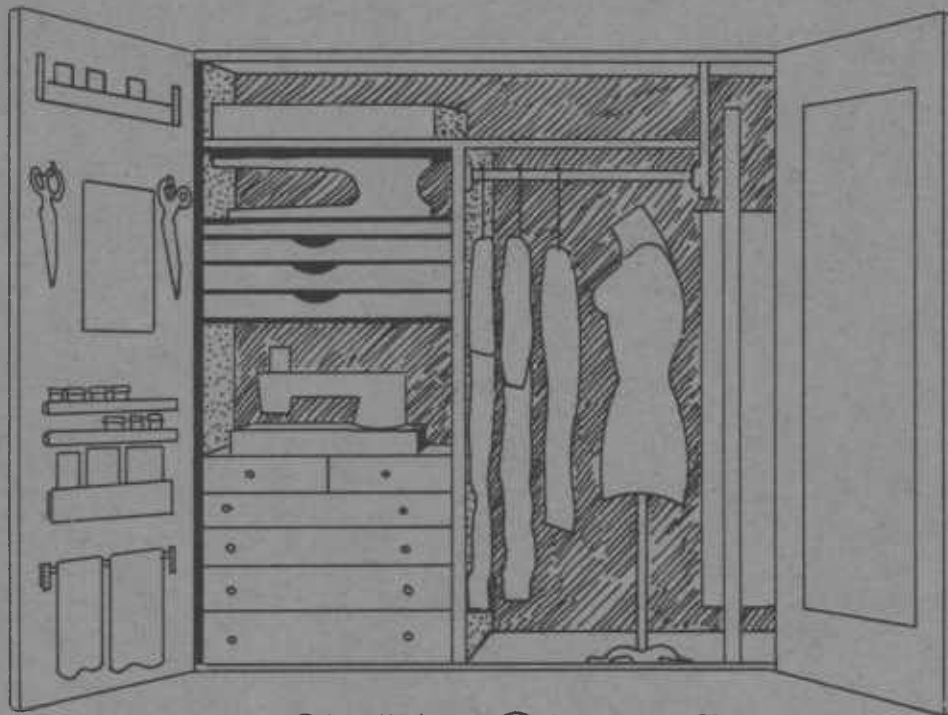

SEWING STORAGE

Width: 48"
Width of drawers: 24"

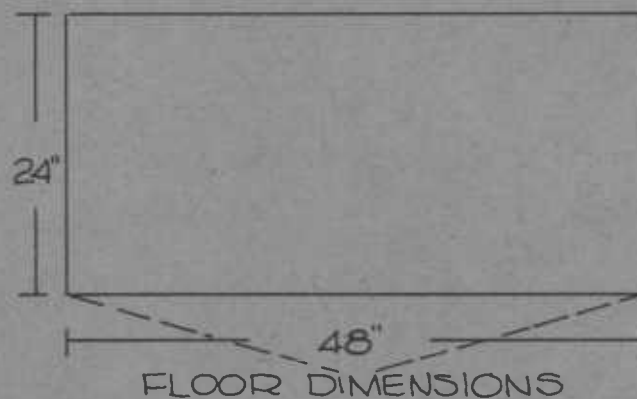

Dining Room Storage

China, linen, glassware, silver, and accessories used in the dining room should be stored there. Access to the cleanup area in the kitchen saves time and energy for the homemaker. This can be accomplished by building a storage wall between the kitchen and the dining room which opens into both rooms.

Items to be Stored

- Table linens
- Flatware
- Hollow ware
- Crystal or glassware
- Centerpiece accessories
- China or pottery

Minimum Storage

- Furniture cabinets

Optimum Storage

- Storage wall opening to kitchen and dining room for crystal and china
- Trays for table cloths and napkins
- Divided drawers for flatware
- Cupboard space for hollow ware and accessories.

Table Linens, Accessories

Note the use of pull-out trays for maximum use of space. Metal serving trays are stored in vertical shelves. Linens and silver are stored in trays and shallow drawers. Open shelving is used to store vases and table accessories.

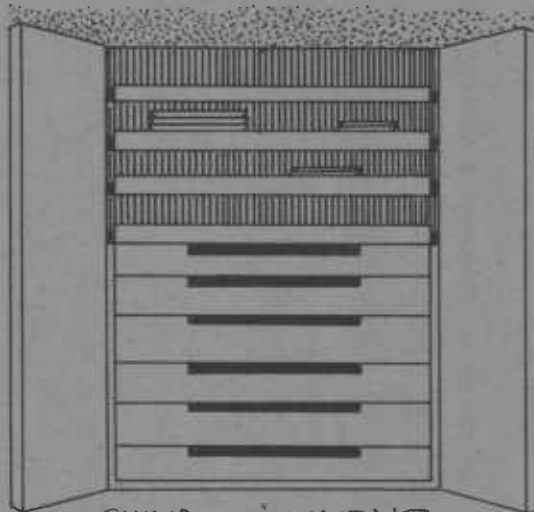

CHINA & LINENS

Height, variable

Multiply number of place settings by 1½ to get linear feet of shelving needed for table service.

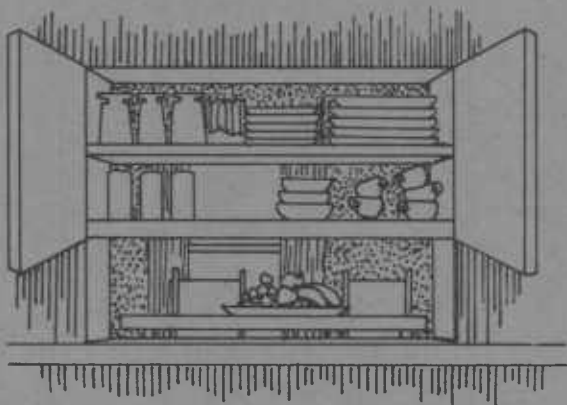

AS SEEN FROM OPPOSITE SIDES

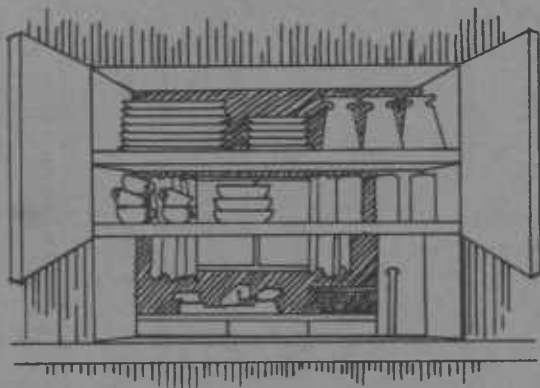

CHINA AND GLASSWARE

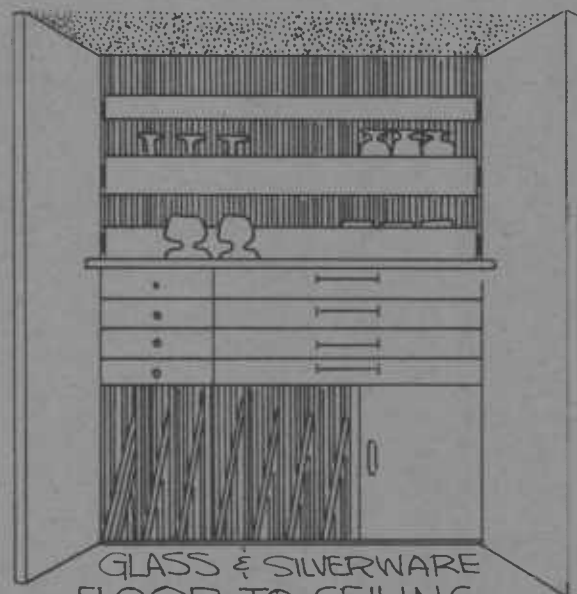

GLASS & SILVERWARE
FLOOR TO CEILING
STORAGE WALL

Suggested dimensions for storage:

Depth: 16" to 20"

Width: 20"

Drawer height: variable

Distance between trays: 4"

Distance between shelves: 2"

Bedroom Storage

Bedroom closet dimensions vary from a minimum of 24" in depth (recommended by the Small Homes Council) to 30" maximum. Twenty four inches is considered standard but will crush bulky clothes such as coats. Preferred dimensions for wardrobe and guest closets are 30" which allows freedom for bulky garments and for circulation of air. Walk-in dressing rooms require that space be allowed for dressing as well as selection of clothes.

Items to be Stored

- Hung clothes
- Folded outerwear
- Underwear, stockings
- Jewelry
- Hats
- Scarves, ties
- Belts

Minimum Storage (per person)

- 48" of clothes rod space
- Shelf above rod
- Drawer space

Optimum Storage (per person)

- Storage wall with built-in shelving, rods, racks and drawers for clothing and accessories.
- Dressing room area with above requirements plus area to dress.

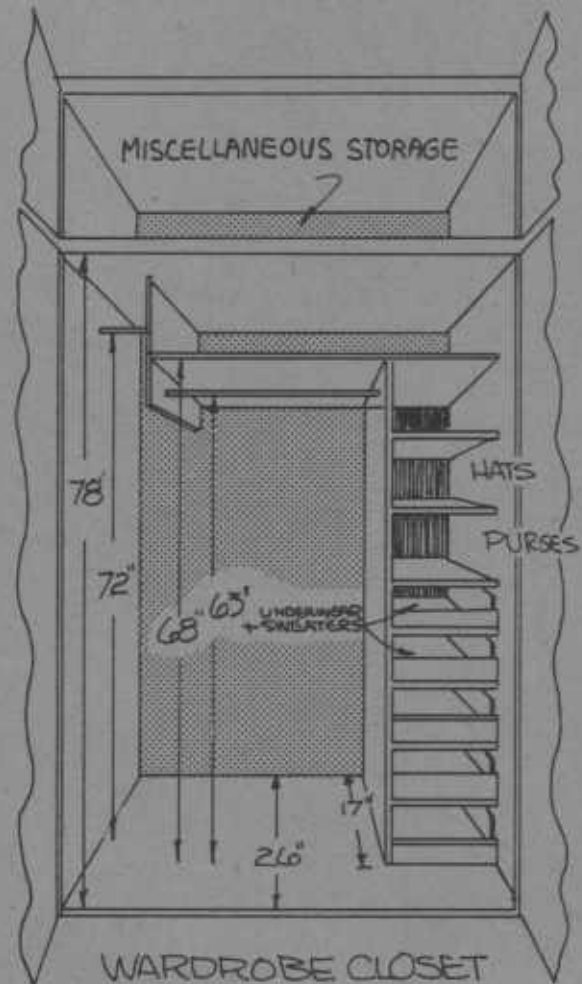

Height: full
Width: variable

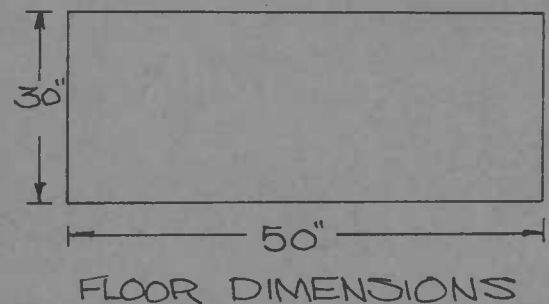

Bedding Storage

Storage for bedding should be located in a central hall near the bedrooms. If bedrooms are located on two floors of the house, plan central linen storage on each floor. The size of a linen closet is determined by the number of sheets, blankets, and pillowcases owned for each bed. Small families with automatic washers and dryers often own less linen than suggested in this bulletin.

Items to be Stored

- Sheets
- Pillowcases
- Mattress covers and pads
- Blankets
- Bedding for guests
- Out-of-season bedding

Minimum Storage

- Central linen closet with adjustable shelving

Optimum Storage

- Central linen storage in hall adjacent to bedroom area
- Built-in trays
- Sorting board

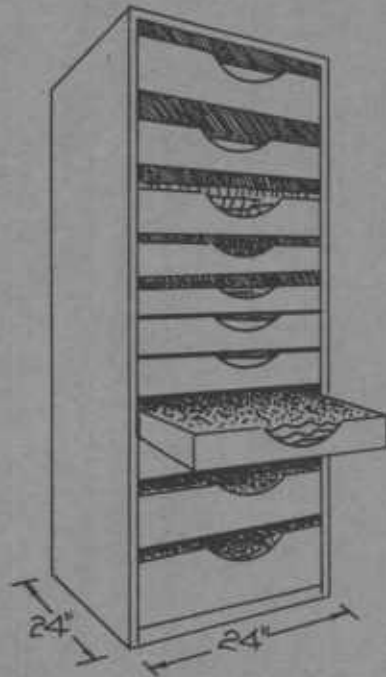

LINEIN CLOSET

A closet with these dimensions would hold 14 quilts, blankets or spreads; 1 comforter, 2 pillows, 2 mattress pads, 24 sheets and 36 pillow slips.

Bathroom Storage

Bathroom storage is determined by the size and variety of purposes for which the bathroom is used. The master bathroom will have more varied and larger storage needs than a guest powder room.

If a bathroom in a master suite is to be used in conjunction with an exercise area, appropriate storage should be planned.

Items to be Stored

- Towels, washclothes
- Bath mats
- Bathing supplies
- Paper products
- Feminine supplies
- Shaving Equipment
- Infant bathtub and bathing supplies
- Cosmetics
- Bathroom cleaning supplies
- Medicine

Minimum Storage

- Racks for towels
- Space for extra supplies such as toilet paper, soap
- Medicine cabinet over lavatory

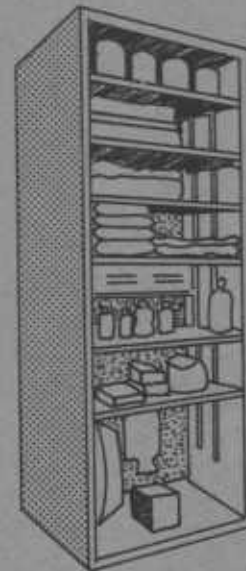

BATHROOM CLOSETS

Optimum Storage

- Cabinet to store supply of bath towels, hand towels, wash clothes
- Cabinet to store grooming aids and cosmetics, shaving supplies, bathing supplies, feminine supplies, paper products
- Locked medicine cabinet
- Storage for equipment for other activities that may take place in or near the master bath such as:

Exercising	Sunbathing
Sauna bathing	Swimming

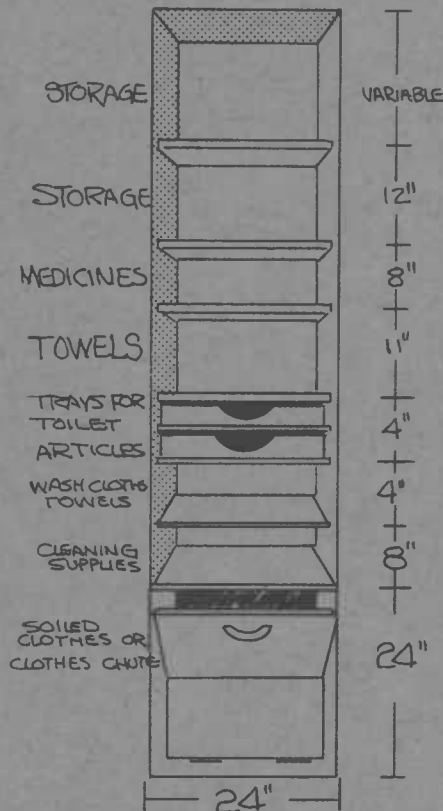

Depth: 24" or 26" minimum
30" maximum
Shelf depth should be 12"

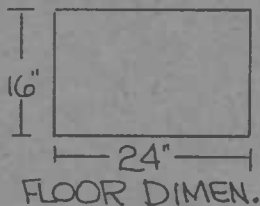

Width: 24"
Height: full
Floor plan: 24"

Recreation and Outdoor Sports Storage

The type of storage for recreation and outdoor sports activities depends upon the interests of the family members.

Items to be Stored

- Wheel toys
- Skis, golf clubs, tennis rackets, etc.
- Fishing tackle
- Hunting supplies
- Camping equipment

Minimum Storage

- Area with outdoor access

Optimum Storage

- Sheltered outdoor area for wheel toys
- Cabinet for skis, poles
- Closet for golf, tennis, croquet, softball, and other sports equipment
- Cabinet for fishing poles and tackle
- Locked cabinet for guns, ammunition
- Area for camping equipment—sleeping bags, tents

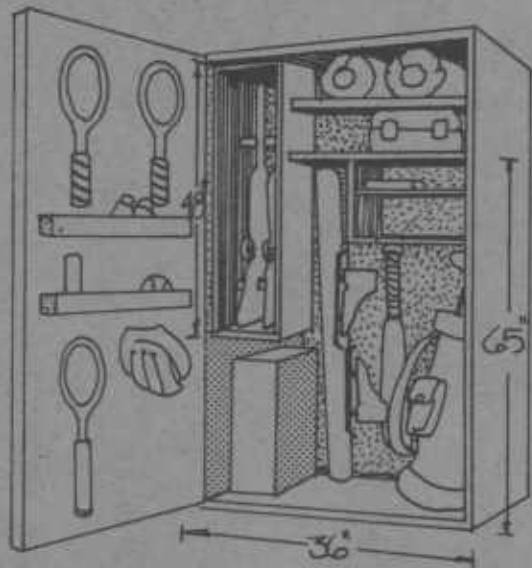

SPORTS CLOSET

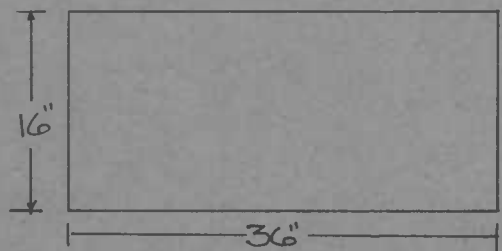

Workshop

Storage space for the workshop is determined by the amount of equipment used in the shop. Space needs to be planned for large table saws in the storage area if they are used in a multipurpose room such as the garage. Hand tools are most easily accounted for when hung on pegboard, generally over the work table. An outline drawn around each tool quickly identifies where it belongs.

Minimum Storage

- Tool Chest or Cabinet

Optimum Storage

- Pegboard wall on which to hang each tool
- Storage area for large pieces of lumber
- Storage area for small pieces of lumber
- Cabinet for hardware
- Bench mounted with equipment

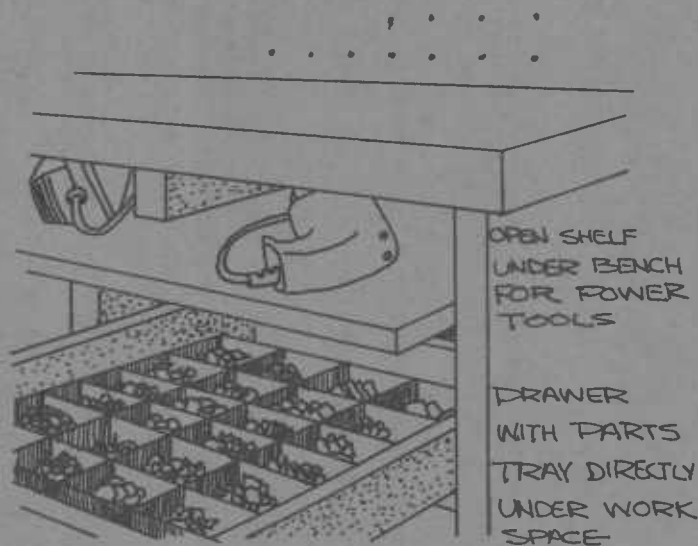
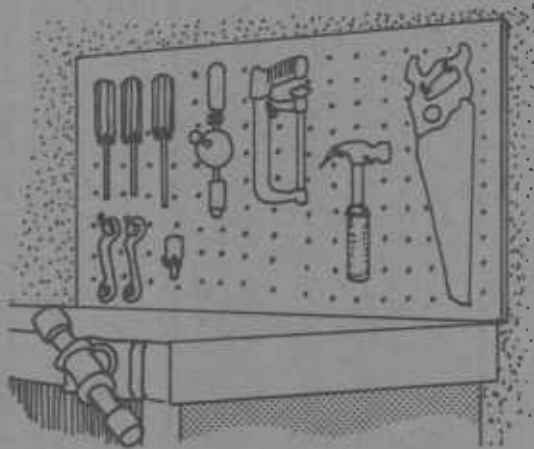

SHOP STORAGE

Garden Tool and Supply Storage

Garden tool and equipment storage may be in part of the house, garage or a separate building depending on the extent of the garden and the equipment needed to tend it.

Items to be Stored

- Lawn mower
- Lawn sweep
- Mulcher
- Hand tools
- Rototiller
- Hoses
- Pruning equipment
- Small tractor
- Potting supplies

Minimum Storage

- Area to hang tools
- Area to park equipment

Optimum Storage

- Area with easy access to outdoors
- Pegboard wall for small tool storage
- Parking area for equipment such as mower, mulcher, rototiller, tractor
- Storage for potting supplies
- Storage for pruning supplies
- Storage for hoses, watering equipment

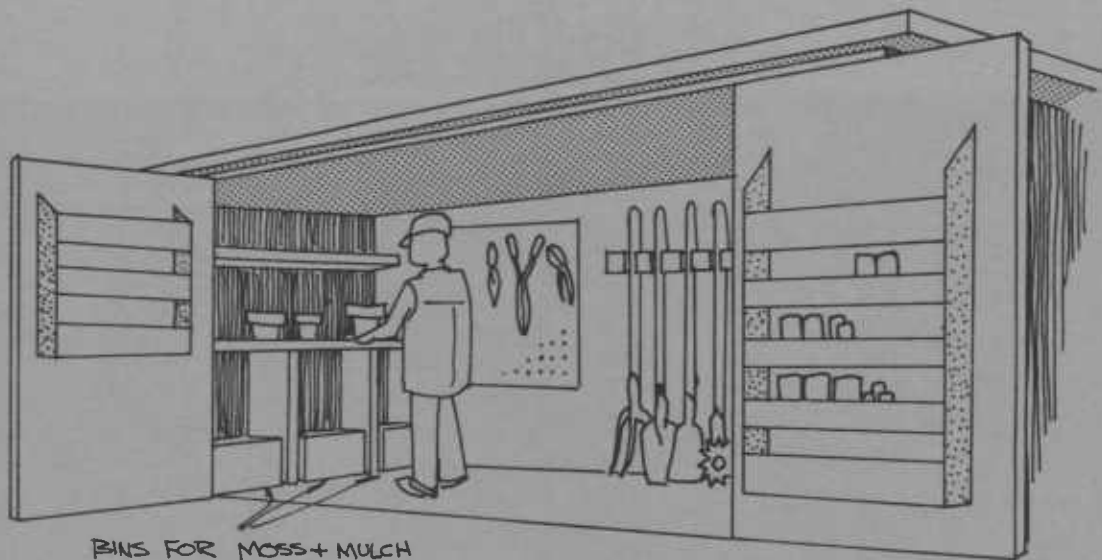

BINS FOR MOSS + MULCH

GARDEN TOOL STORAGE

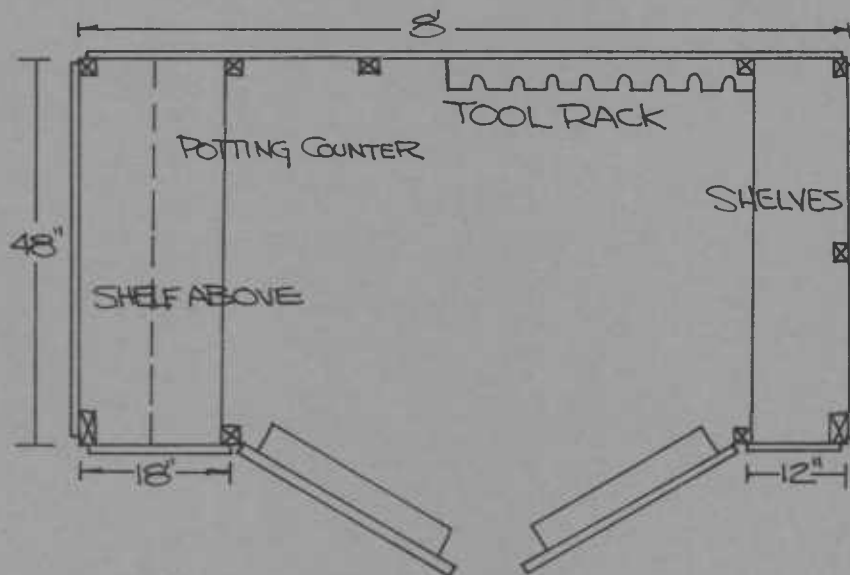

DIMENSIONS

Storage ideas have been presented in this bulletin with suggested dimensions for minimum and optimum storage areas. These ideas are meant to be a guide when building or remodeling a home. Your county Extension office has other publications which will further help you with your plans.

"Storage for Kids' Stuff," EC 805

"Storage Accessories," EC 804

"Better Kitchen Storage," PNW 47



OREGON STATE UNIVERSITY
**EXTENSION
SERVICE**

Extension Service, Oregon State University, Corvallis, Lee R. Kolmer, director. This publication was produced and distributed in furtherance of the Acts of Congress of May 8 and June 30, 1914. Extension work is a cooperative program of Oregon State University, the U. S. Department of Agriculture, and Oregon counties.
